



A-19361
Kimball County, NE

Latitude: 41.3826°N
Longitude: -103.9023°W
Imagery Source: USDA NAIP
Soil Data Source: USDA NRCS
Boundaries Are Approximate



Map		NON IRR	IRR		IRR	
Symbol	Name	LCC	LCC	NCCPI	CORN	ACRES
1512	Altvan-Satanta loams, 0 to 1 percent slopes	IIIc	IIIs	28	127	219.5
6041	Tassel-Blanche sandy loams, 3 to 9 percent slopes	VIs	IVe	12	28	74.0
6032	Tassel-Blanche complex, 9 to 30 percent slopes	VIs	---	8	---	8.5
1739	Rosebud-Canyon loams, 1 to 3 percent slopes	IVe	IIIe	21	75	4.0
Total				23.5	98.9	306.0



A-19361
Kimball County, NE

Latitude: 41.3826°N
 Longitude: -103.9023°W
 Imagery Source: USDA NAIP
 Soil Data Source: USDA NRCS
 Boundaries Are Approximate

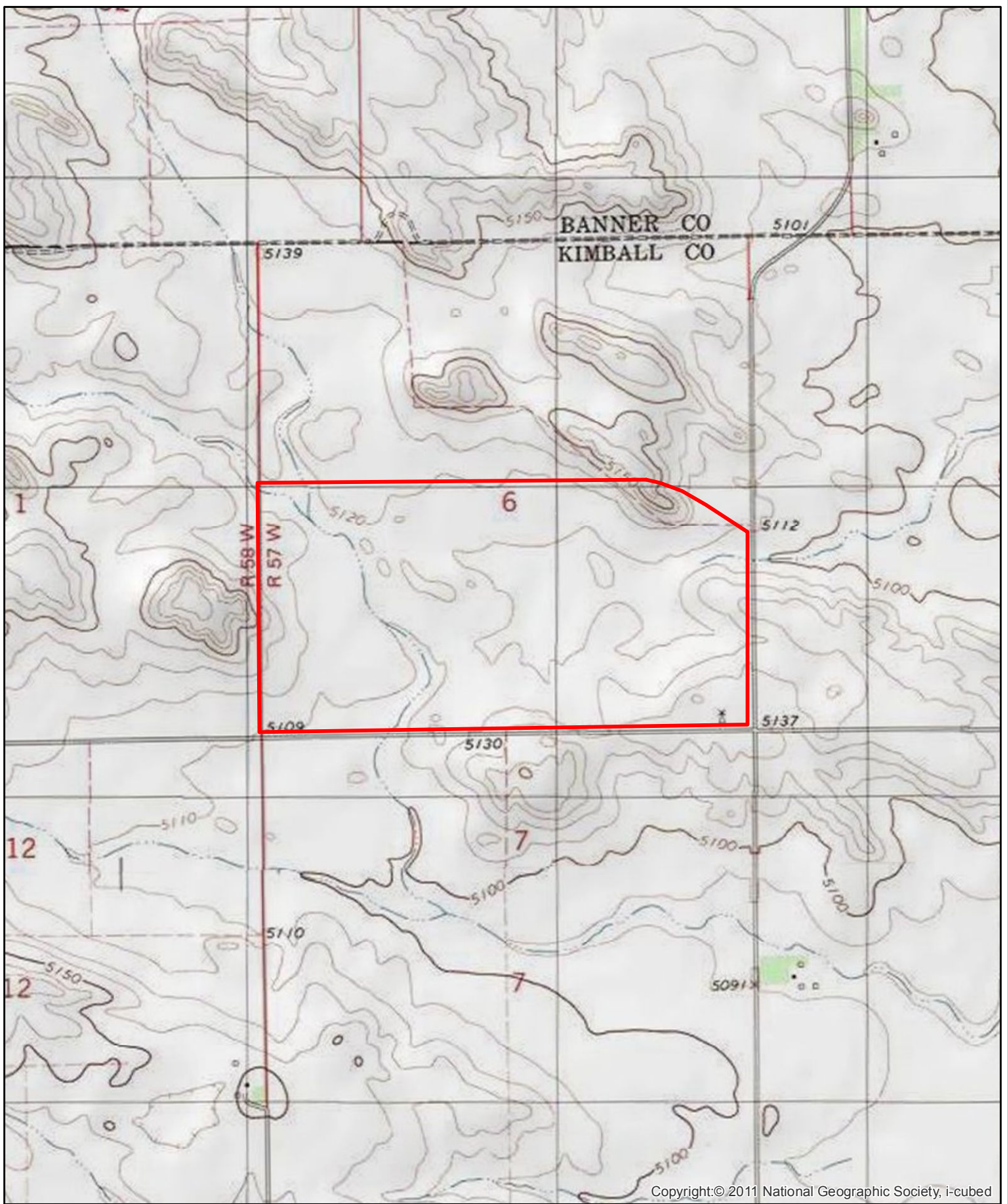

A-19361
Kimball County, NE

Latitude: 41.3826°N
Longitude: -103.9023°W
Imagery Source: USDA NAIP
Soil Data Source: USDA NRCS
Boundaries Are Approximate

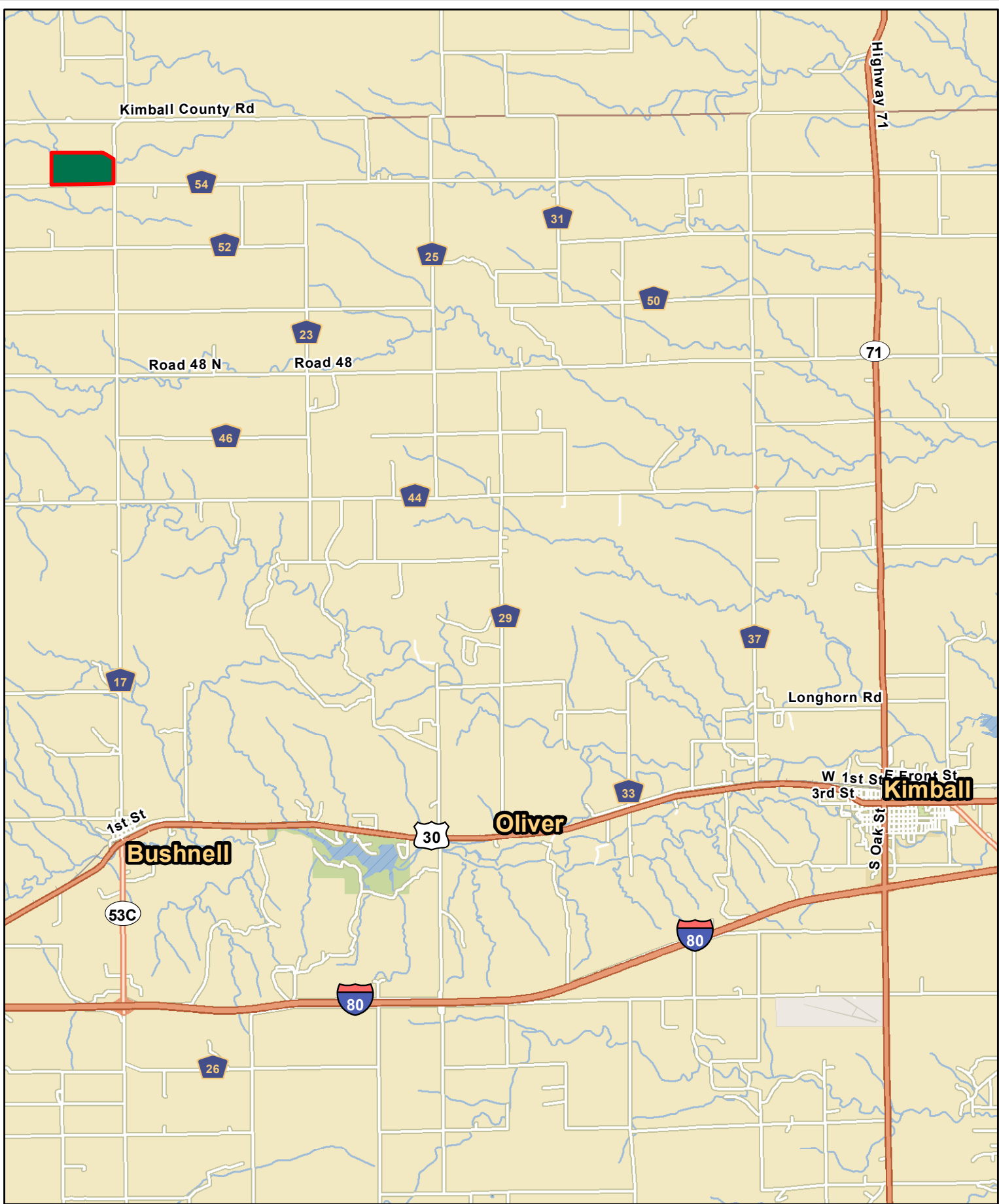

A-19361
Kimball County, NE

Latitude: 41.2816°N
Longitude: -103.7776°W
Imagery Source: USDA NAIP
Soil Data Source: USDA NRCS
Boundaries Are Approximate