

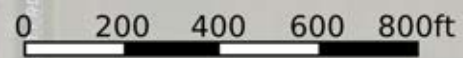

 Boundary



 Boundary



 Boundary

|  Boundary 77.3 ac

| SOIL CODE | SOIL DESCRIPTION  | ACRES   | %     | CPI | NCCPI | CAP  |
|-----------|---|---------|-------|-----|-------|------|
| Pc        | Paulding clay, 0 to 1 percent slopes                          | 43.03   | 55.66 | 0   | 43    | 3w   |
| HkA       | Haskins loam, 0 to 2 percent slopes                           | 22.61   | 29.25 | 0   | 77    | 2w   |
| RnA       | Roselms loam, 0 to 2 percent slopes                           | 5.42    | 7.01  | 0   | 50    | 3w   |
| RoA       | Roselms silty clay loam, 0 to 2 percent slopes                | 4.58    | 5.92  | 0   | 48    | 3w   |
| HaA       | Haskins loamy sand, 0 to 2 percent slopes                     | 0.81    | 1.05  | 0   | 74    | 2w   |
| BsC3      | Broughton silty clay, 6 to 12 percent slopes, severely eroded | 0.71    | 0.92  | 0   | 32    | 6e   |
| Me        | Mermill loam  | 0.14    | 0.18  | 0   | 69    | 2w   |
| TOTALS    |   | 77.3(*) | 100%  | -   | 54.0  | 2.72 |

(\*) Total acres may differ in the second decimal compared to the sum of each acreage soil. This is due to a round error because we only show the acres of each soil with two decimal.



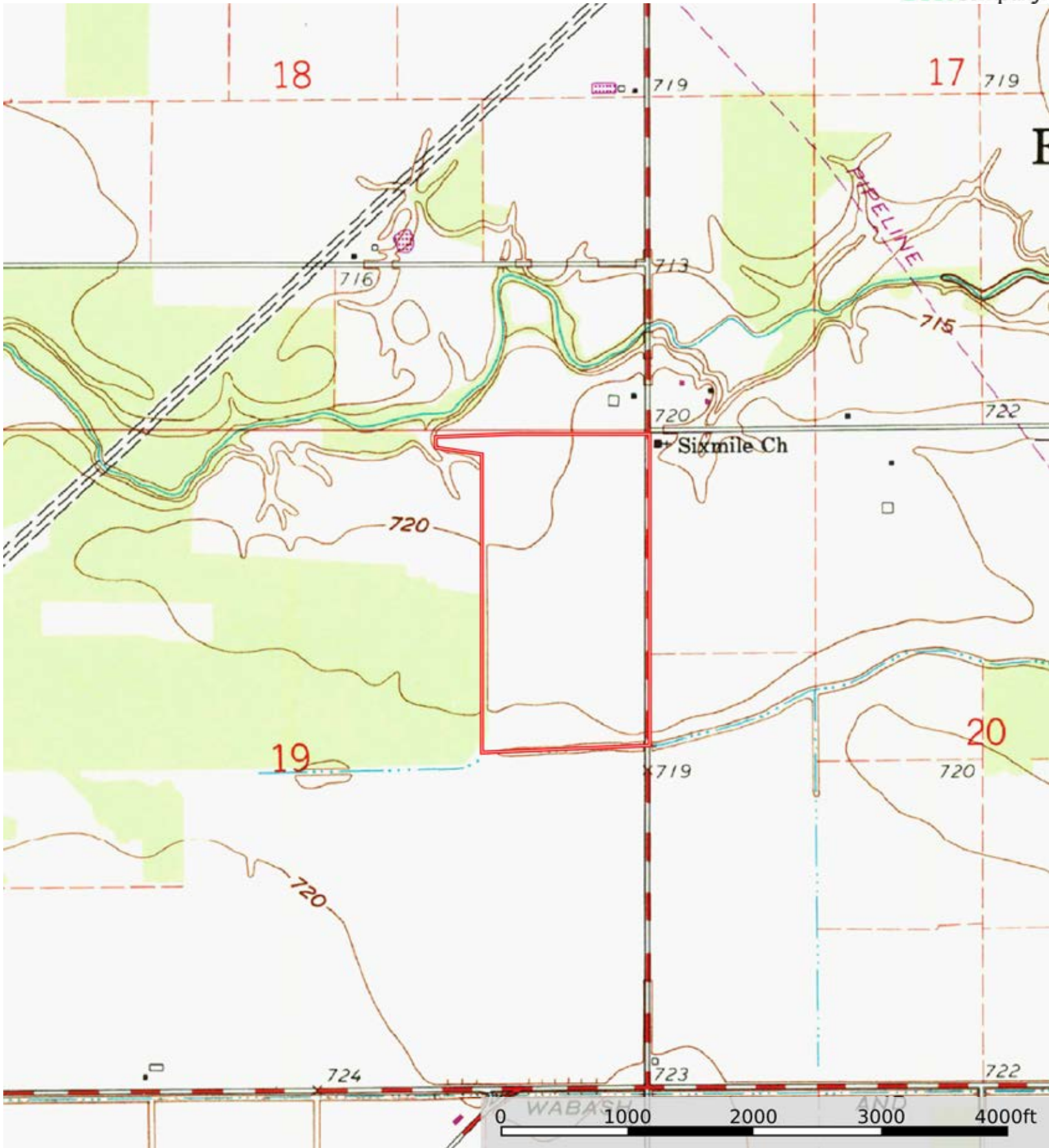

 Boundary