

EXHIBIT A-1

Being a tract or parcel of land situated about 11 miles S.E. of the Court House in Parker County, Texas and embracing portions of the S. B. Kutch Survey, the I. & G.N.R.R. Co. Surveys, Sections 5 & 6 in Block 9, and the J. V. Schick Survey, all in Parker County, Texas and more particularly that same tract as recorded in Vol 241, page 472, Deed Records, Parker County, Texas, from W. M. Landers and Mrs: Jewell E. Landers to Houston P. Hutchens, and being the same tract or parcel of land conveyed by The Cambridge Companies, Inc., a Texas corporation, to Emma Jean Floyd the 20th day of December, 1973, and described by metes and bounds as follows:

BEGINNING at the S. W. Corner of said S. B. Kutch Survey in the East line of said I. & G.N.R.R. Co. Survey, a stone with a car axle driven beside it for corner;

THENCE North 80 degrees 30' West along a fence 1537.2 feet to a car axle driven beside a stone for corner, the east corner of a survey in the name of Ribble;

THENCE North 27 degrees 18' 02" East along a fence 3226.58 feet to an iron pin for the Northwest corner of said Kutch Survey and a re-entrant corner of said I. & G.N.R.R. Co. Survey, Section #5;

THENCE North 0 degrees 03' 27" East along a fence to an iron pin for corner in the Southerly R.O.W. line of State Highway #171;

THENCE Southeasterly along the Southerly line of said Highway, South 77 degrees 17' 54" East 1350.0 feet to an iron pin, South 73 degrees 02' 55" East 395.52 feet an iron pin, South 71 degrees 07' 55" East 1399.37 feet an iron pin, South 66 degrees 54' 56" East 234.81 feet an iron pin, South 60 degrees 20' 56" East 152.0 feet an iron pin, South 53 degrees 36' 56" East 263.59 feet an iron pin, South 44 degrees 36' 54" East 363.57 feet an iron pin, South 40 degrees 27' 55" East 758.13 feet to an iron pin at the beginning of a curve to the right having a radius of 1673.61 feet (long chord bearing South 23 degrees 40' 45" East 997.23 feet), then along said curve to the right 1012.61 feet to a concrete monument at the end of curve and then South 7 degrees 10' 33" East 570.47 feet to an iron pin for corner in the South line of said Kutch Survey;

THENCE South 89 degrees 27' 48" West along the South line of said Kutch Survey 4763.35 feet to the point of beginning and containing 347.207 acres of land.

Building Sketch

Borrower	None				
Property Address	9896 State Highway 171				
City	Weatherford	County	Johnson	State	TX
Zip Code	76087				
Lender/Client	C. A. Floyd				

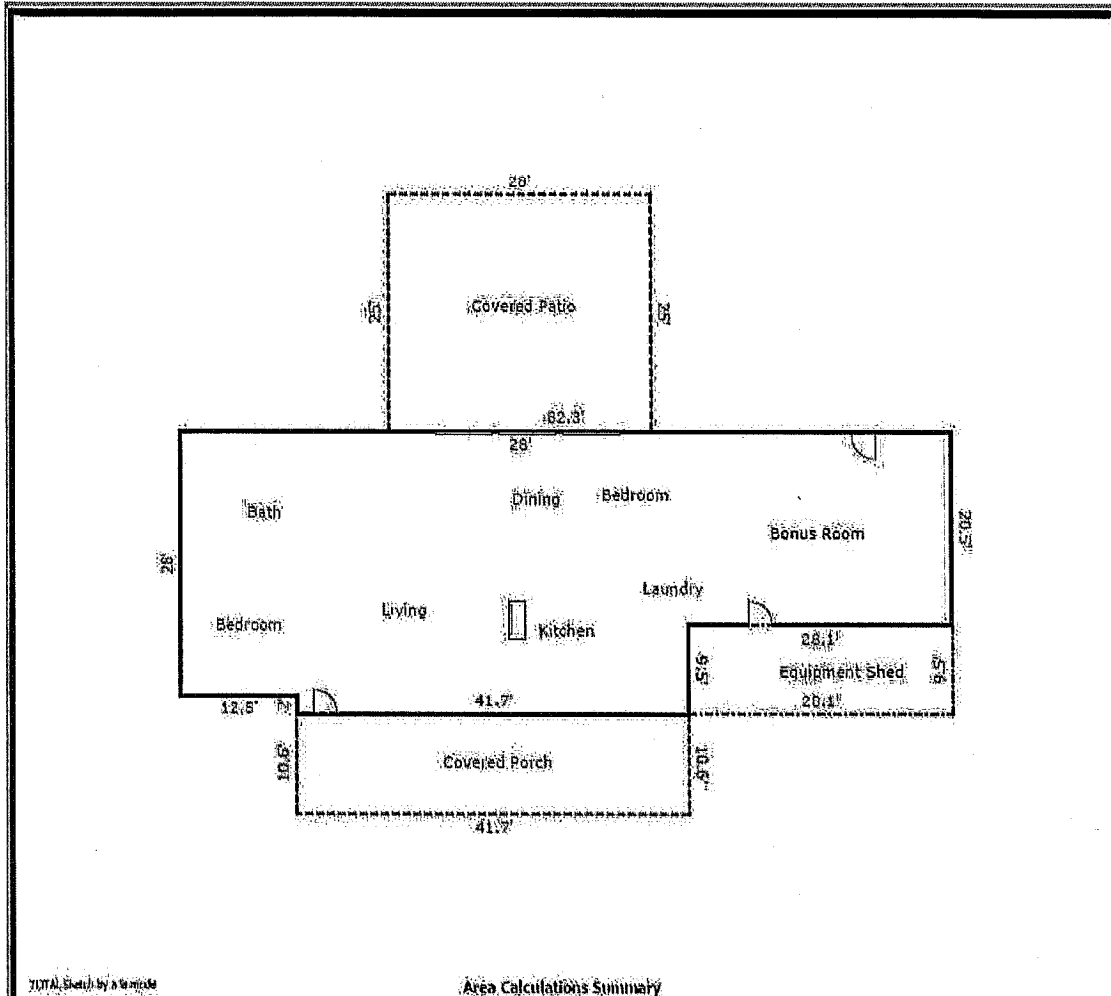

TOTAL Sketch by a la mode

Area Calculations Summary

Living Area	Area	Calculation Details
First Floor	2177.1 Sq ft	$20.5 \times 28.1 = 576$ $30 \times 41.7 = 1251$ $28 \times 12.5 = 350$
Total Living Area (Rounded):	2177 Sq ft	
Non-Living Area		
Covered Front Porch	442 Sq ft	$41.7 \times 10.6 = 442$
Covered Patio	700 Sq ft	$28 \times 25 = 700$
Equipment Shed	267 Sq ft	$9.5 \times 28.1 = 267$

TOTAL Sketch software by a la mode technologies, llc. 1-800-alamode