

Illini FS, a division of GROWMARK - TOLONO



103 S Long
Tolono IL 61880
217/485-6810 Fax: 217/485-3575

Invoice

73016168

PHILLIP KLEISS
1037 CR 800 N
TOLONO, IL 61880

Invoice Date 05/23/2022
Due Date 06/25/2022 Regular
Customer ID 2288426
Salesperson 0046
Shipping Loc. 073
Field ID HOGANSE HOGAN SOUTH EAST

Quantity	Description	Unit Price	Total \$	%	Your Share
397.800 EA	SOIL TEST 2.5 ACRE GRID BASIC	7.00 /EA	2,784.60	33.3300	928.11

Terms: THIS INVOICE WILL APPEAR ON YOUR NEXT MONTHLY STATEMENT

Sub Total 928.11
Amount Due 928.11

This Invoice is Shared With

	Regular %
PHILLIP KLEISS	33.33
KRISTOPHER KLEISS	33.33
JERRY KLEISS	33.34

Remit To: ILLINI FS
Tolono Facility
103 S Long
Tolono IL 61880

PHILLIP KLEISS

Invoice

73016168
Customer Copy



a division of GROWMARK, Inc.

1509 East University Avenue, Urbana, IL 61802 • Phone (217) 384 - 8300 • www.illinifs.com

Operator: Phillip Kleiss
Farm/Field: Phil Kle/HOGAN SE
Acres: 397.8

Field ID: 168436
Date: 05/03/2022
Submitted By: ILLINI FS VRT (TOLONO)

Legend

Base Map

-  Water
-  Roads
-  Timber
-  Waterway
-  Buildings

Latitude: 39.945225
Longitude: -88.189448
Grid Size: 330nsx330ew

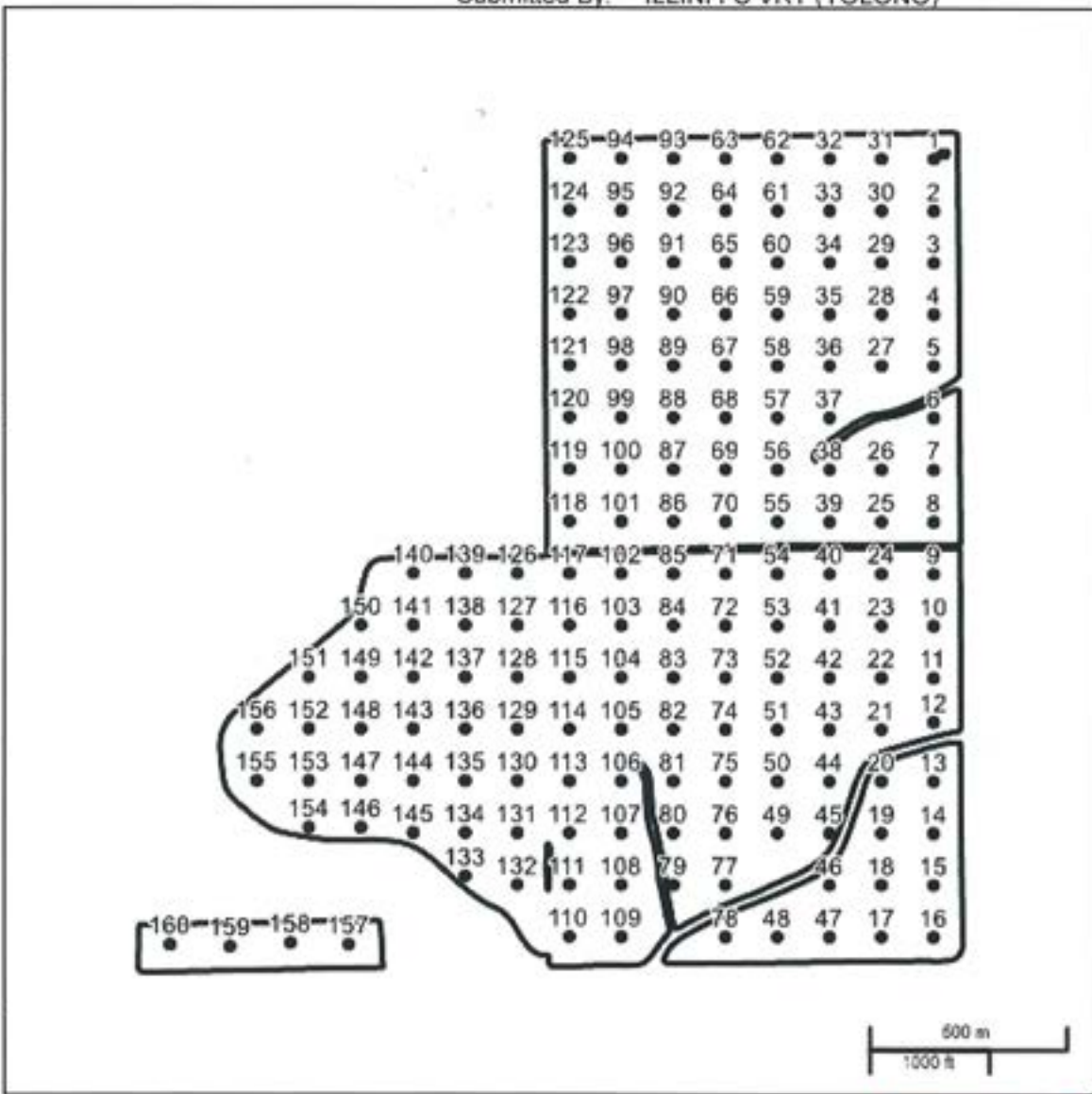

Bringing you what's next.





Since 1983

KSI LABORATORIES

202 S. DACEY DR., SHELBYVILLE, ILLINOIS 62565
 PHONE (217) 774-2421
 www.KSILab.com



OPERATOR: Phil Kleiss
FIELD: Phil Kle/HOGAN SE
ACRES: 397.8

LAB#: 38682-41 (4370)
DATE: 04/28/2022
SUBMITTED BY: ILLINI FS VRT (TOLONO)

SOIL TEST RESULTS

SAMPLE#	SOIL pH	BUFFER pH	PHOSPHORUS lbs/A	POTASSIUM lbs/A	CALCIUM lbs/A	MAGNESIUM lbs/A	ORGANIC MATTER %	CATION EXCHANGE CAPACITY	BASE SATURATION			
									%Ca	%Mg	%K	%H
1	7.3	-	182	833	-	-	3.0	-	-	-	-	
2	6.4	-	37	233	-	-	3.3	-	-	-	-	
3	6.5	-	119	469	-	-	3.4	-	-	-	-	
4	6.4	-	69	378	-	-	3.4	-	-	-	-	
5	6.4	-	21	267	-	-	3.3	-	-	-	-	
6	6.7	-	38	332	-	-	2.8	-	-	-	-	
7	6.4	-	56	359	-	-	3.3	-	-	-	-	
8	6.1	-	27	290	-	-	3.2	-	-	-	-	
9	6.6	-	26	302	-	-	3.3	-	-	-	-	
10	6.7	-	25	292	-	-	3.2	-	-	-	-	
11	6.8	-	20	320	-	-	3.4	-	-	-	-	
12	6.6	-	63	353	-	-	3.4	-	-	-	-	
13	6.8	-	26	238	-	-	3.4	-	-	-	-	
14	6.8	-	48	337	-	-	3.2	-	-	-	-	
15	6.8	-	23	277	-	-	3.3	-	-	-	-	
16	6.8	-	32	279	-	-	3.3	-	-	-	-	
17	6.7	-	36	231	-	-	2.7	-	-	-	-	
18	6.7	-	30	233	-	-	3.2	-	-	-	-	
19	6.9	-	28	226	-	-	3.0	-	-	-	-	
20	6.7	-	26	281	-	-	3.4	-	-	-	-	
21	6.6	-	43	315	-	-	3.5	-	-	-	-	
22	6.5	-	34	307	-	-	3.3	-	-	-	-	
23	6.4	-	36	280	-	-	3.2	-	-	-	-	
24	6.7	-	24	261	-	-	3.3	-	-	-	-	
25	6.8	-	72	321	-	-	3.4	-	-	-	-	
26	6.7	-	45	263	-	-	3.0	-	-	-	-	
27	6.4	-	40	307	-	-	3.4	-	-	-	-	
28	6.4	-	38	356	-	-	3.4	-	-	-	-	
29	6.8	-	40	313	-	-	3.3	-	-	-	-	
30	6.7	-	30	243	-	-	3.0	-	-	-	-	
31	6.4	-	74	685	-	-	3.4	-	-	-	-	
32	6.9	-	30	295	-	-	3.0	-	-	-	-	
33	6.7	-	34	330	-	-	3.4	-	-	-	-	
34	6.9	-	28	300	-	-	3.0	-	-	-	-	
35	6.5	-	69	331	-	-	3.2	-	-	-	-	
36	6.3	-	54	399	-	-	2.8	-	-	-	-	
37	6.5	-	76	378	-	-	3.4	-	-	-	-	
38	6.5	-	63	346	-	-	3.2	-	-	-	-	
39	6.5	-	35	289	-	-	3.4	-	-	-	-	
40	6.5	-	22	259	-	-	2.8	-	-	-	-	
41	6.7	-	27	314	-	-	3.4	-	-	-	-	
42	6.8	-	41	293	-	-	3.4	-	-	-	-	



Since 1983

KSI LABORATORIES

202 S. DACEY DR., SHELBYVILLE, ILLINOIS 62565
 PHONE (217) 774-2421
 www.KSILab.com



OPERATOR: Phil Kleiss
FIELD: Phil Kle/HOGAN SE
ACRES: 397.8

LAB#: 38682-41 (4370)
DATE: 04/28/2022
SUBMITTED BY: ILLINI FS VRT (TOLONO)

SOIL TEST RESULTS

SAMPLE#	SOIL pH	BUFFER pH	PHOSPHORUS lbs/A	POTASSIUM lbs/A	CALCIUM lbs/A	MAGNESIUM lbs/A	ORGANIC MATTER %	CATION EXCHANGE CAPACITY	BASE SATURATION			
									%Ca	%Mg	%K	%H
43	6.9	-	51	257	-	-	3.3	-	-	-	-	
44	6.7	-	48	300	-	-	3.2	-	-	-	-	
45	7.1	-	70	349	-	-	3.4	-	-	-	-	
46	7.1	-	138	580	-	-	3.0	-	-	-	-	
47	7.0	-	43	307	-	-	2.4	-	-	-	-	
48	6.9	-	26	282	-	-	2.5	-	-	-	-	
49	6.7	-	38	282	-	-	2.3	-	-	-	-	
50	6.8	-	38	206	-	-	2.2	-	-	-	-	
51	6.8	-	72	305	-	-	2.4	-	-	-	-	
52	6.9	-	25	273	-	-	2.8	-	-	-	-	
53	6.5	-	56	275	-	-	3.4	-	-	-	-	
54	7.2	-	30	302	-	-	3.2	-	-	-	-	
55	6.5	-	36	323	-	-	3.3	-	-	-	-	
56	6.7	-	41	312	-	-	3.2	-	-	-	-	
57	6.9	-	41	294	-	-	3.4	-	-	-	-	
58	6.4	-	53	318	-	-	3.4	-	-	-	-	
59	6.5	-	45	303	-	-	3.3	-	-	-	-	
60	6.6	-	39	379	-	-	3.4	-	-	-	-	
61	6.3	-	39	363	-	-	3.0	-	-	-	-	
62	6.5	-	61	343	-	-	3.3	-	-	-	-	
63	6.8	-	45	340	-	-	3.4	-	-	-	-	
64	6.5	-	44	318	-	-	3.6	-	-	-	-	
65	6.4	-	71	445	-	-	3.5	-	-	-	-	
66	6.1	-	63	352	-	-	3.4	-	-	-	-	
67	6.2	-	34	287	-	-	3.2	-	-	-	-	
68	6.6	-	43	322	-	-	3.3	-	-	-	-	
69	6.5	-	42	269	-	-	3.2	-	-	-	-	
70	6.1	-	51	290	-	-	3.3	-	-	-	-	
71	6.3	-	58	224	-	-	2.6	-	-	-	-	
72	6.5	-	42	338	-	-	2.5	-	-	-	-	
73	6.6	-	39	290	-	-	2.4	-	-	-	-	
74	6.5	-	106	328	-	-	2.4	-	-	-	-	
75	6.4	-	64	347	-	-	2.5	-	-	-	-	
76	7.0	-	31	398	-	-	2.3	-	-	-	-	
77	6.8	-	30	340	-	-	2.0	-	-	-	-	
78	6.9	-	32	328	-	-	2.4	-	-	-	-	
79	6.7	-	25	256	-	-	2.2	-	-	-	-	
80	6.7	-	24	224	-	-	2.5	-	-	-	-	
81	6.3	-	36	204	-	-	2.4	-	-	-	-	
82	6.6	-	40	233	-	-	2.3	-	-	-	-	
83	6.5	-	46	233	-	-	2.7	-	-	-	-	
84	6.5	-	38	204	-	-	2.5	-	-	-	-	



Since 1983

KSI LABORATORIES

202 S. DACEY DR., SHELBYVILLE, ILLINOIS 62565
 PHONE (217) 774-2421
 www.KSILab.com



OPERATOR: Phil Kleiss
FIELD: Phil Kle/HOGAN SE
ACRES: 397.8

LAB#: 38682-41 (4370)
DATE: 04/28/2022
SUBMITTED BY: ILLINI FS VRT (TOLONO)

SOIL TEST RESULTS

SAMPLE#	SOIL pH	BUFFER pH	PHOSPHORUS lbs/A	POTASSIUM lbs/A	CALCIUM lbs/A	MAGNESIUM lbs/A	ORGANIC MATTER %	CATION EXCHANGE CAPACITY	BASE SATURATION			
									%Ca	%Mg	%K	%H
85	6.4	-	42	286	-	-	3.0	-	-	-	-	
86	6.5	-	34	250	-	-	2.4	-	-	-	-	
87	6.4	-	85	340	-	-	2.8	-	-	-	-	
88	6.3	-	55	311	-	-	3.2	-	-	-	-	
89	6.2	-	36	293	-	-	3.0	-	-	-	-	
90	6.4	-	51	321	-	-	2.8	-	-	-	-	
91	6.2	-	83	365	-	-	3.0	-	-	-	-	
92	6.5	-	54	334	-	-	3.3	-	-	-	-	
93	6.6	-	57	333	-	-	3.4	-	-	-	-	
94	6.4	-	59	344	-	-	3.5	-	-	-	-	
95	6.4	-	88	352	-	-	3.4	-	-	-	-	
96	6.7	-	30	351	-	-	2.4	-	-	-	-	
97	6.3	-	42	290	-	-	3.4	-	-	-	-	
98	6.5	-	29	288	-	-	3.4	-	-	-	-	
99	6.2	-	104	292	-	-	3.3	-	-	-	-	
100	6.5	-	45	319	-	-	2.5	-	-	-	-	
101	6.7	-	33	269	-	-	2.4	-	-	-	-	
102	6.5	-	42	247	-	-	2.5	-	-	-	-	
103	6.5	-	47	233	-	-	2.5	-	-	-	-	
104	6.8	-	41	378	-	-	2.3	-	-	-	-	
105	6.7	-	35	211	-	-	2.4	-	-	-	-	
106	6.5	-	17	268	-	-	2.2	-	-	-	-	
107	6.8	-	23	232	-	-	2.3	-	-	-	-	
108	6.9	-	31	295	-	-	2.5	-	-	-	-	
109	6.7	-	18	231	-	-	2.3	-	-	-	-	
110	6.8	-	25	177	-	-	2.4	-	-	-	-	
111	6.8	-	27	221	-	-	2.4	-	-	-	-	
112	6.6	-	22	229	-	-	2.3	-	-	-	-	
113	6.3	-	28	233	-	-	2.6	-	-	-	-	
114	6.4	-	51	220	-	-	2.8	-	-	-	-	
115	6.8	-	20	236	-	-	2.5	-	-	-	-	
116	6.6	-	24	200	-	-	2.4	-	-	-	-	
117	6.7	-	43	211	-	-	2.6	-	-	-	-	
118	6.5	-	50	357	-	-	2.4	-	-	-	-	
119	6.3	-	30	331	-	-	2.5	-	-	-	-	
120	6.6	-	47	276	-	-	2.4	-	-	-	-	
121	6.2	-	42	299	-	-	2.8	-	-	-	-	
122	6.2	-	57	273	-	-	2.5	-	-	-	-	
123	6.2	-	41	431	-	-	2.6	-	-	-	-	
124	6.1	-	37	313	-	-	2.6	-	-	-	-	
125	6.6	-	87	359	-	-	2.8	-	-	-	-	
126	6.6	-	26	327	-	-	2.4	-	-	-	-	



Since 1983

KSI LABORATORIES

202 S. DACEY DR., SHELBYVILLE, ILLINOIS 62565

PHONE (217) 774-2421

www.KSILab.com



OPERATOR: Phil Kleiss
FIELD: Phil Kle/HOGAN SE
ACRES: 397.8

LAB#: 38682-41 (4370)
DATE: 04/28/2022
SUBMITTED BY: ILLINI FS VRT (TOLONO)

SOIL TEST RESULTS

SAMPLE#	SOIL pH	BUFFER pH	PHOSPHORUS lbs/A	POTASSIUM lbs/A	CALCIUM lbs/A	MAGNESIUM lbs/A	ORGANIC MATTER %	CATION EXCHANGE CAPACITY	BASE SATURATION			
									%Ca	%Mg	%K	%H
127	6.2	-	31	243	-	-	2.5	-	-	-	-	-
128	6.3	-	32	348	-	-	2.3	-	-	-	-	-
129	6.2	-	59	365	-	-	2.7	-	-	-	-	-
130	6.4	-	35	352	-	-	2.4	-	-	-	-	-
131	6.2	-	34	374	-	-	2.6	-	-	-	-	-
132	6.4	-	27	388	-	-	2.4	-	-	-	-	-
133	6.5	-	28	324	-	-	2.5	-	-	-	-	-
134	6.2	-	69	332	-	-	2.5	-	-	-	-	-
135	6.5	-	36	421	-	-	2.4	-	-	-	-	-
136	6.3	-	62	320	-	-	2.6	-	-	-	-	-
137	6.4	-	33	318	-	-	2.3	-	-	-	-	-
138	6.2	-	74	310	-	-	2.6	-	-	-	-	-
139	6.8	-	52	409	-	-	2.4	-	-	-	-	-
140	6.6	-	37	346	-	-	2.3	-	-	-	-	-
141	5.9	-	48	308	-	-	2.4	-	-	-	-	-
142	6.3	-	37	309	-	-	2.8	-	-	-	-	-
143	6.6	-	28	296	-	-	3.0	-	-	-	-	-
144	7.0	-	24	290	-	-	2.6	-	-	-	-	-
145	7.0	-	35	349	-	-	2.7	-	-	-	-	-
146	6.4	-	31	398	-	-	2.4	-	-	-	-	-
147	6.5	-	45	257	-	-	2.8	-	-	-	-	-
148	6.4	-	38	287	-	-	3.3	-	-	-	-	-
149	6.7	-	48	323	-	-	3.0	-	-	-	-	-
150	6.6	-	52	350	-	-	2.4	-	-	-	-	-
151	6.4	-	54	349	-	-	2.6	-	-	-	-	-
152	6.5	-	33	232	-	-	2.5	-	-	-	-	-
153	6.7	-	22	279	-	-	2.5	-	-	-	-	-
154	6.9	-	101	598	-	-	2.4	-	-	-	-	-
155	6.8	-	46	297	-	-	2.6	-	-	-	-	-
156	6.1	-	33	260	-	-	2.6	-	-	-	-	-
157	6.8	-	22	215	-	-	2.5	-	-	-	-	-
158	6.9	-	21	260	-	-	2.3	-	-	-	-	-
159	6.6	-	31	225	-	-	2.5	-	-	-	-	-
160	6.7	-	35	233	-	-	2.7	-	-	-	-	-
AVERAGE	6.6	-	45	311	-	-	2.9	-	-	-	-	-
PH AVE.	6.6	EXTRACTED SAMPLES: 1,54,										
P1 AVE.	40	EXTRACTED SAMPLES: 1, 3,46,74,87,91,95,99,25,36,54,										
K AVE.	300	EXTRACTED SAMPLES: 1, 3,31,46,54,										