

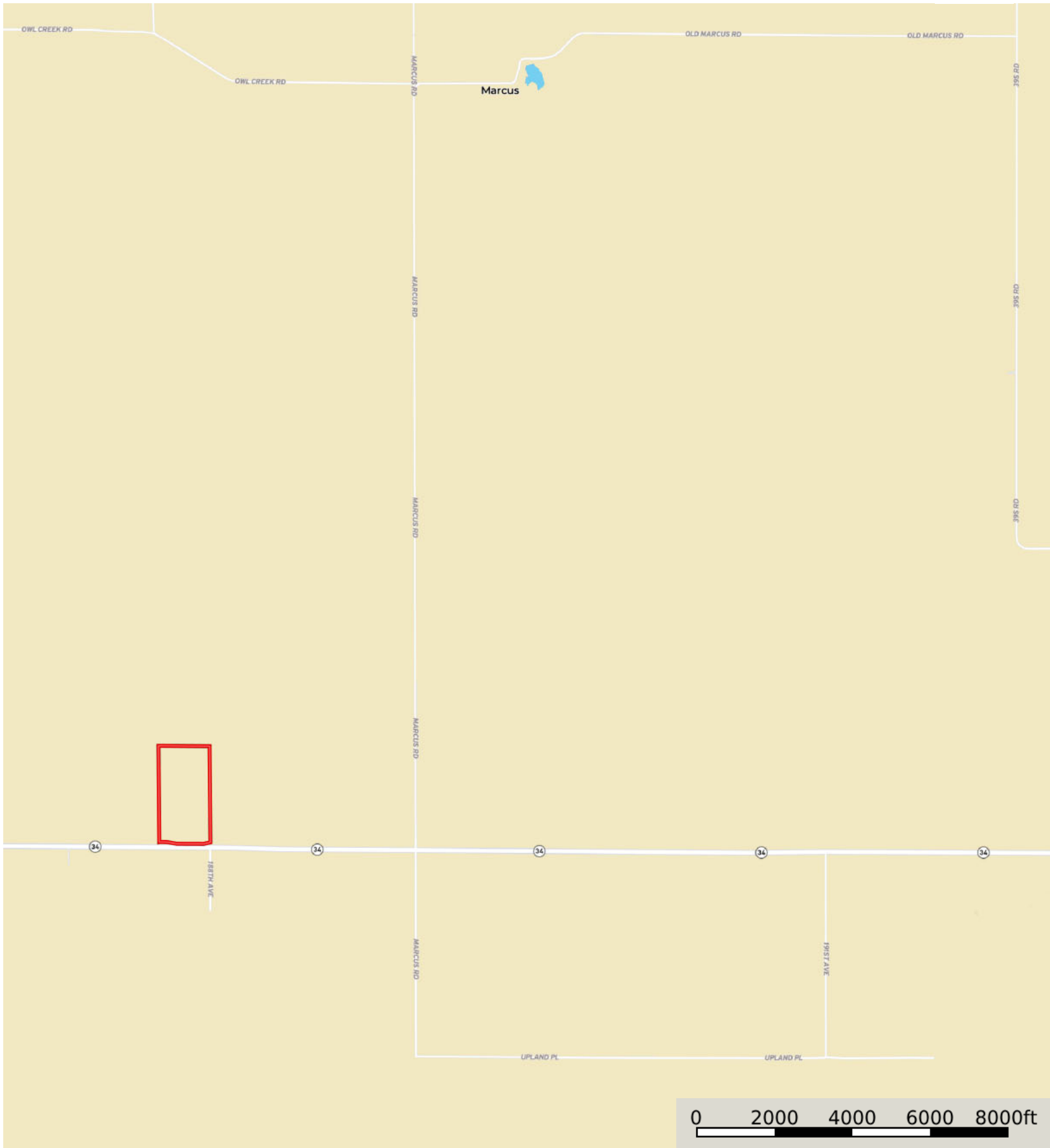

L-2300368

Meade County, South Dakota, 77.25 AC +/-



 Boundary

L-2300368

Meade County, South Dakota, 77.25 AC +/-



 Boundary

L-2300368

Meade County, South Dakota, 77.25 AC +/-



 Boundary

|  Boundary 75.8 ac

SOIL CODE	SOIL DESCRIPTION	ACRES	%	CPI	NCCPI	CAP
GaA	Gerdrum loam, 0 to 4 percent slopes	49.41	65.18	36	15	4s
EdB	Eapa-Delridge loams, 2 to 6 percent slopes	26.39	34.82	72	32	2e
TOTALS		75.8(*)	100%	48.53	20.92	3.3









(*) Total acres may differ in the second decimal compared to the sum of each acreage soil. This is due to a round error because we only show the acres of each soil with two decimal.

Capability Legend

Increased Limitations and Hazards

Decreased Adaptability and Freedom of Choice Users

Land, Capability

								
	1	2	3	4	5	6	7	8
'Wild Life'	•	•	•	•	•	•	•	•
Forestry	•	•	•	•	•	•	•	
Limited	•	•	•	•	•	•	•	
Moderate	•	•	•	•	•	•		
Intense	•	•	•	•	•			
Limited	•	•	•	•				
Moderate	•	•	•					
Intense	•	•						
Very Intense	•							

Grazing Cultivation

(c) climatic limitations (e) susceptibility to erosion

(s) soil limitations within the rooting zone (w) excess of water

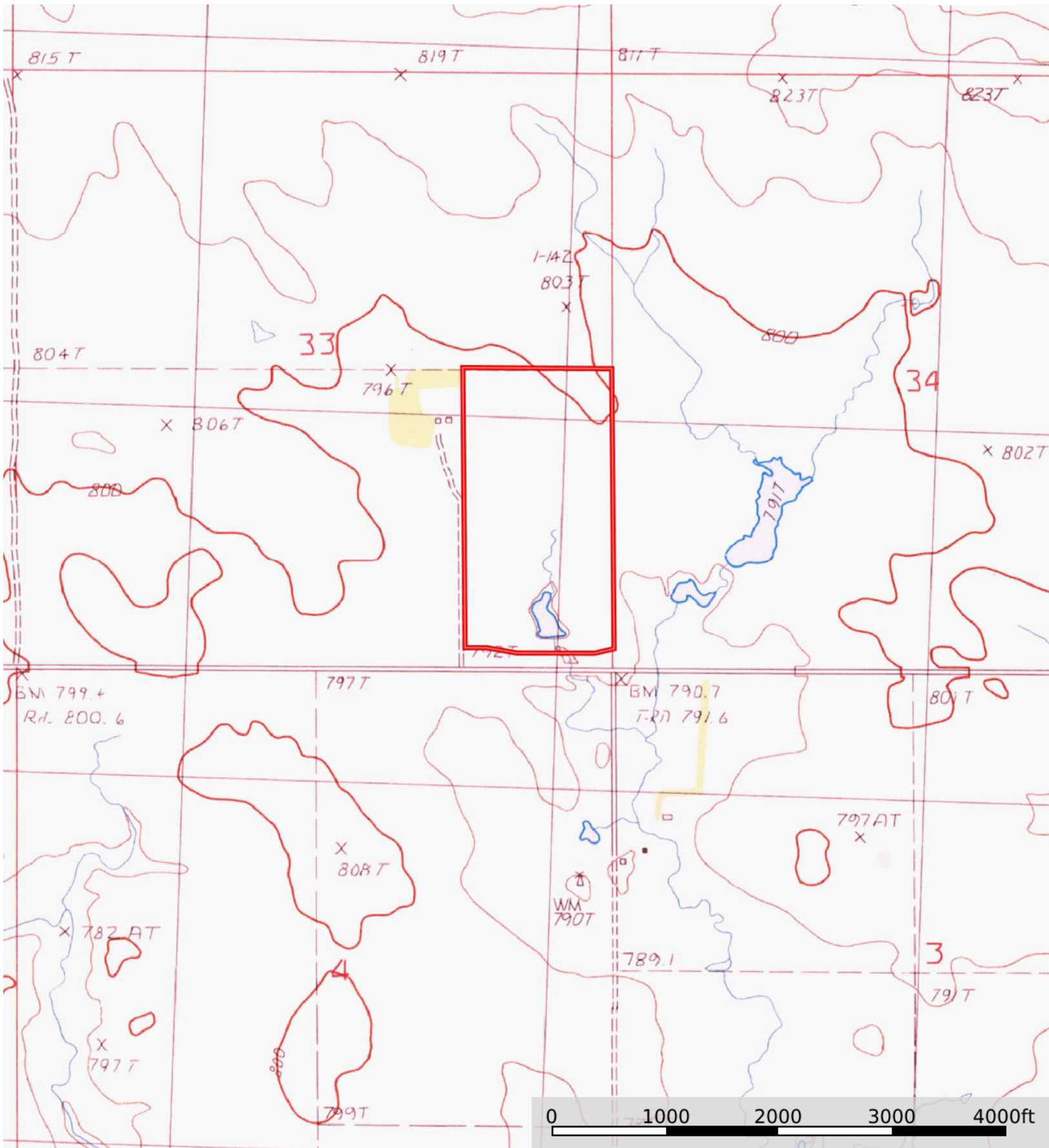

 Boundary