

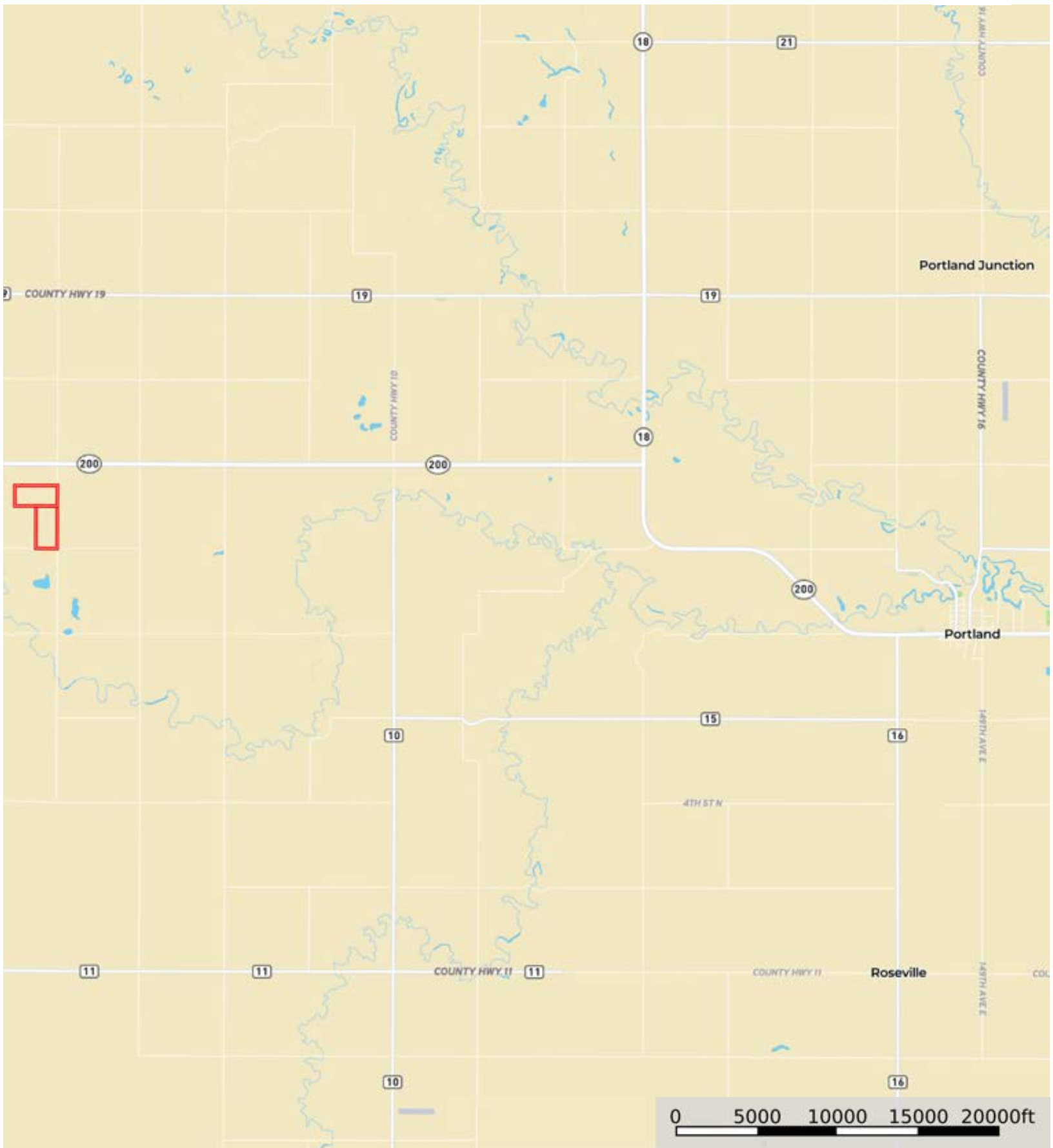

L-2300592

Steele County, North Dakota, 160 AC +/-



 Boundary



The information contained herein was obtained from sources deemed to be reliable. Land id™ Services makes no warranties or guarantees as to the completeness or accuracy thereof.

L-2300592

Steele County, North Dakota, 160 AC +/-



 Boundary

L-2300592

Steele County, North Dakota, 160 AC +/-



 Boundary



The information contained herein was obtained from sources deemed to be reliable. Land id™ Services makes no warranties or guarantees as to the completeness or accuracy thereof.

|  Boundary 77.46 ac

SOIL CODE	SOIL DESCRIPTION	ACRES	%	CPI	NCCPI	CAP
I400A	Gilby loam, 0 to 2 percent slopes	42.22	54.51	78	65	2e
I857A	Wyndmere-Tiffany complex, stratified substratum, 0 to 2 percent slopes	24.32	31.4	71	52	3e
I269A	Kratka fine sandy loam, 0 to 1 percent slopes	9.09	11.74	31	57	4w
I405A	Antler clay loam, 0 to 2 percent slopes	1.83	2.36	83	61	2e
TOTALS		77.46(*)	100%	70.4	59.89	2.55

(*) Total acres may differ in the second decimal compared to the sum of each acreage soil. This is due to a round error because we only show the acres of each soil with two decimal.



L-2300592

Steele County, North Dakota, 160 AC +/-



 Boundary

|  Boundary 80.17 ac

SOIL CODE	SOIL DESCRIPTION	ACRES	%	CPI	NCCPI	CAP
1857A	Wyndmere-Tiffany complex, stratified substratum, 0 to 2 percent slopes	40.76	50.84	71	52	3e
1400A	Gilby loam, 0 to 2 percent slopes	35.76	44.61	78	65	2e
1269A	Kratka fine sandy loam, 0 to 1 percent slopes	3.65	4.55	31	57	4w
TOTALS		80.17(*)	100%	72.3	58.03	2.6

(*) Total acres may differ in the second decimal compared to the sum of each acreage soil. This is due to a round error because we only show the acres of each soil with two decimal.



L-2300592

Steele County, North Dakota, 160 AC +/-

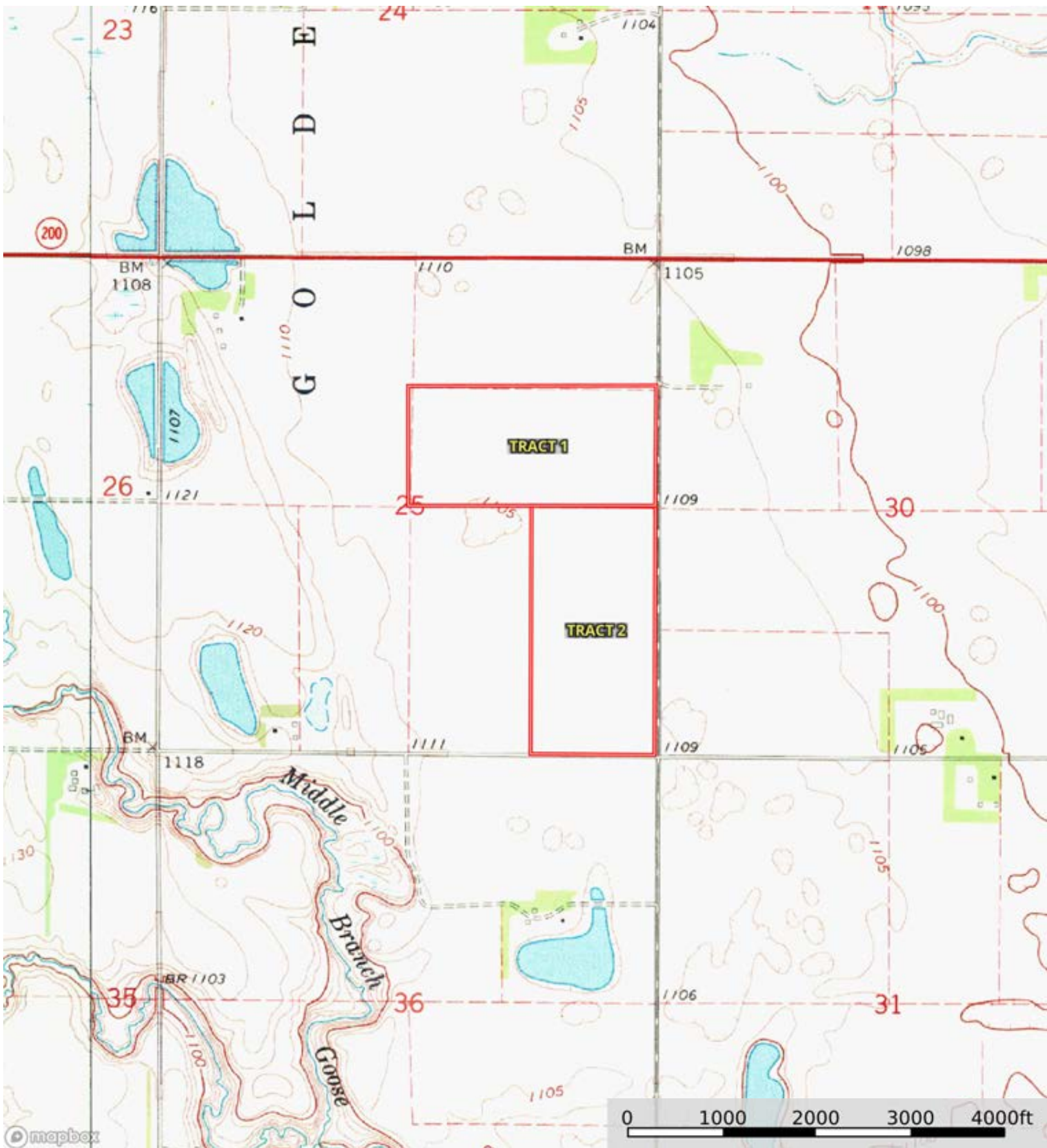

mapbox

Boundary