

L-2400101

Grand Forks County, North Dakota, 79.18 AC +/-



Boundary

L-2400101

Grand Forks County, North Dakota, 79.18 AC +/-



 Boundary

L-2400101

Grand Forks County, North Dakota, 79.18 AC +/-



 Boundary

|  Boundary 79.47 ac

SOIL CODE	SOIL DESCRIPTION	ACRES	%	CPI	NCCPI	CAP
I601A	Bearden silty clay loam, moderately saline, 0 to 2 percent slopes	78.57	98.87	52	33	3s
I370A	Rauville silty clay loam, 0 to 1 percent slopes, frequently flooded	0.9	1.13	34	7	5w
TOTALS		79.47(*)	100%	51.8	32.71	3.02

(*) Total acres may differ in the second decimal compared to the sum of each acreage soil. This is due to a round error because we only show the acres of each soil with two decimal.



L-2400101

Grand Forks County, North Dakota, 79.18 AC +/-

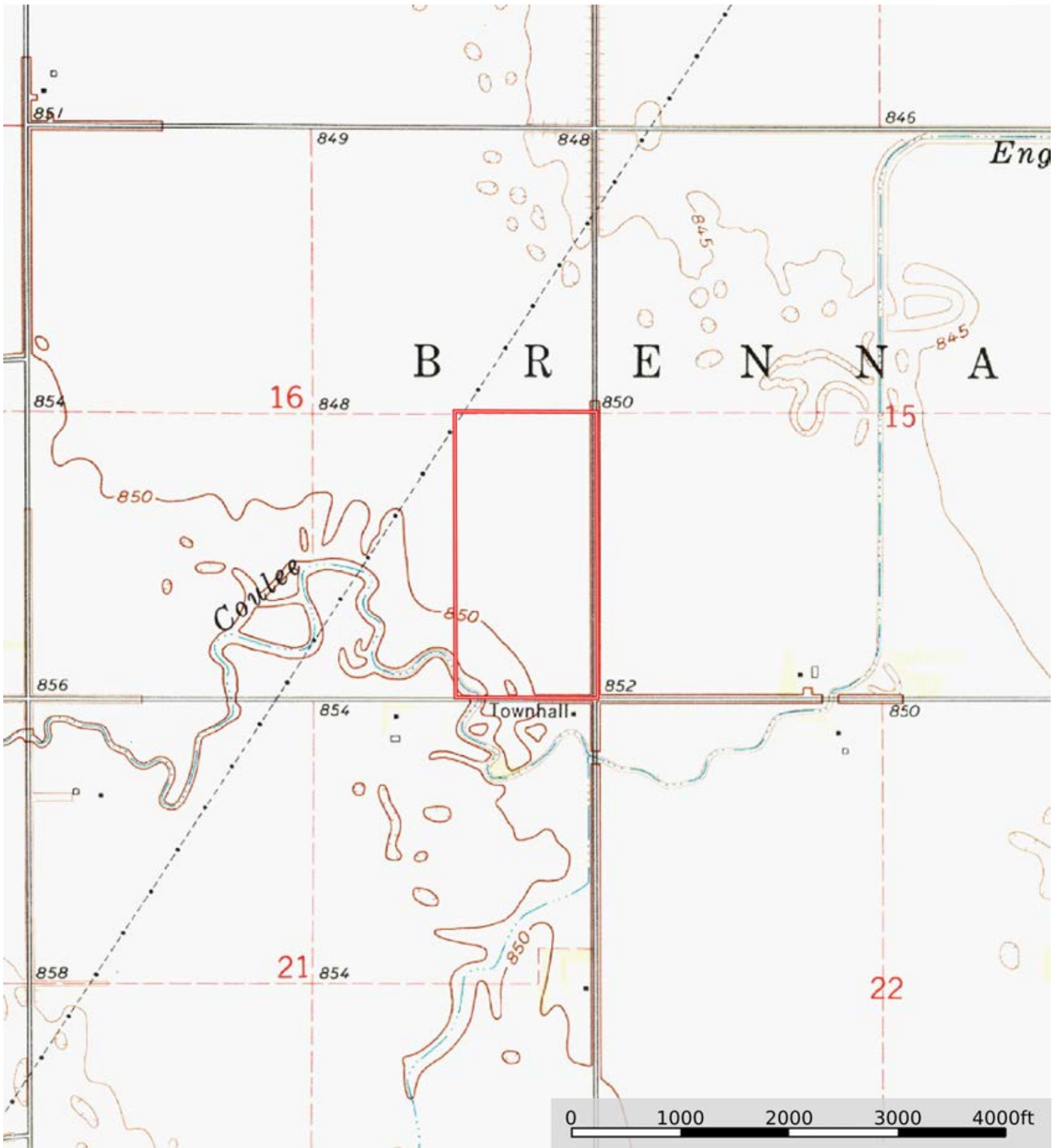

 Boundary



The information contained herein was obtained from sources deemed to be reliable. Land id™ Services makes no warranties or guarantees as to the completeness or accuracy thereof.