





 Boundary



 Boundary



 Boundary



|  Boundary 157.49 ac

SOIL CODE	SOIL DESCRIPTION	ACRES	%	CPI	NCCPI	CAP
I47A	Poppleton fine sand, 0 to 2 percent slopes	40.73	25.86	45	25	4s
I98A	Ulen fine sandy loam, dense till, 0 to 2 percent slopes	34.21	21.72	55	32	3e
I91A	Rosewood fine sandy loam, dense till, 0 to 1 percent slopes	25.79	16.38	55	32	3w
I108A	Syrene sandy loam, dense till, 0 to 2 percent slopes	19.55	12.41	39	19	4w
I48A	Radium loamy sand, 0 to 2 percent slopes	12.07	7.66	39	26	4s
I97A	Cormant loamy fine sand, dense till, 0 to 2 percent slopes	11.99	7.61	45	27	4w
I109A	Fluvaquents, 0 to 2 percent slopes, frequently flooded	9.12	5.79	20	7	6w
I100A	Cormant and Rosewood soils, very poorly drained, 0 to 1 percent slopes	4.03	2.56	15	19	6w
TOTALS		157.49(*)	100%	45.39	25.96	3.79

(*) Total acres may differ in the second decimal compared to the sum of each acreage soil. This is due to a round error because we only show the acres of each soil with two decimal.



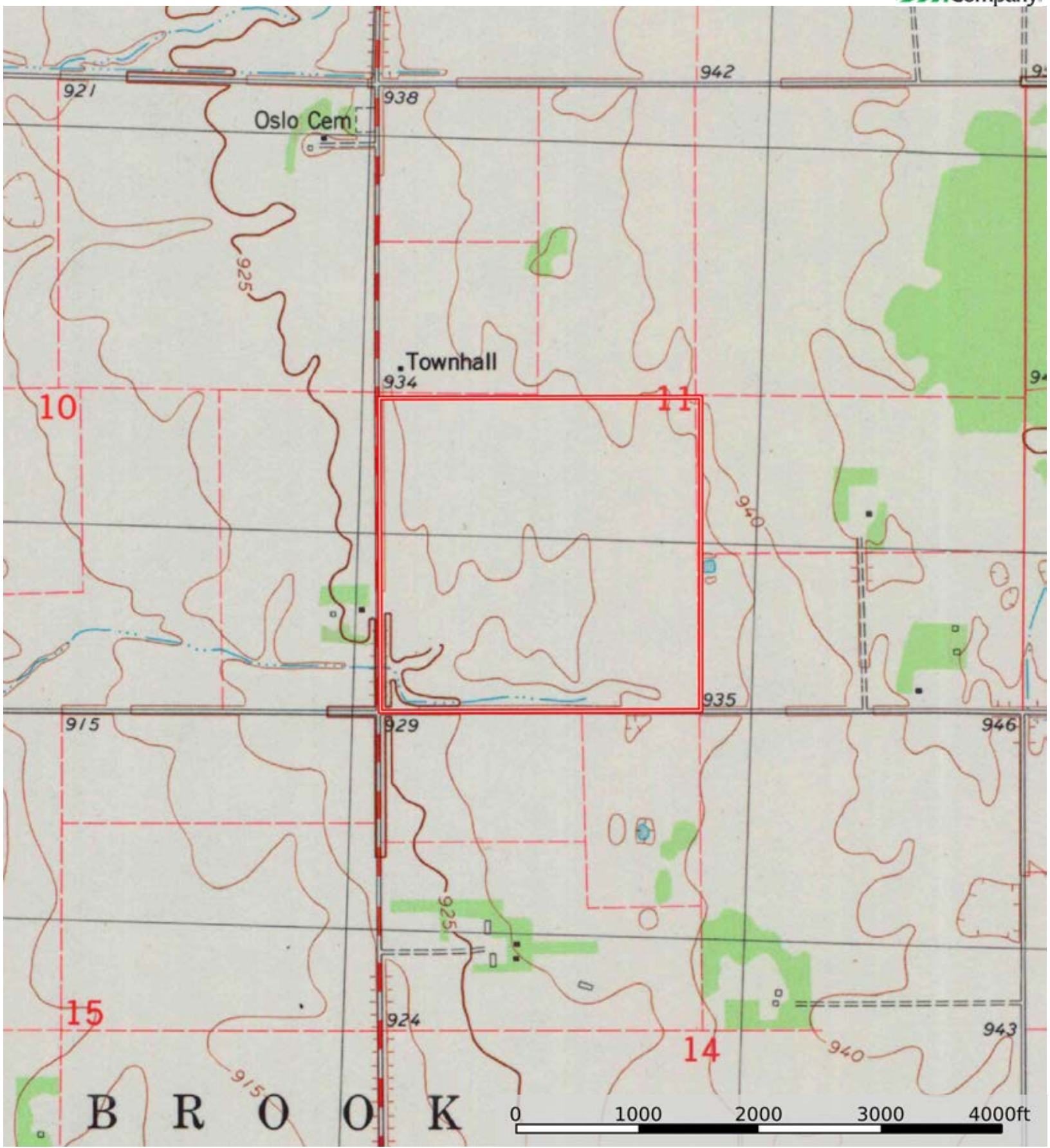

 Boundary