



Farmers
National
Company™

www.FarmersNational.com

L-2400403



SCAN THE QR CODE
FOR MORE INFO!



LAND FOR SALE

468± Acres, Hodgeman County, Kansas

OFFERED AT
\$750,000

Highlights:

- Pasture and cropland straight north of Hanston, Kansas
- Predominantly Class II soils on the cropland



For additional information, please contact:

Matt Foos, AFM, Agent | (620) 255-1811

MFoos@FarmersNational.com

Property Information

Directions to Properties:

3.25 miles north of Hanston, Kansas, on 228 Road.

Property Description:

Combination pasture and cropland tract located north of Hanston, Kansas.

Legal Description:

E/2 and SW/4 of Section 34-21S-22W

2023 Taxes:

- \$989.00

FSA Information:

	Base	Yield
Wheat	61.2 acres	44 bushels
Grain Sorghum	54.5 acres	61 bushels

Farm Data:

Cropland	162.02 acres
Pasture	304.35 acres
Other	1.63 acres
Total	468.00 acres

Property Location

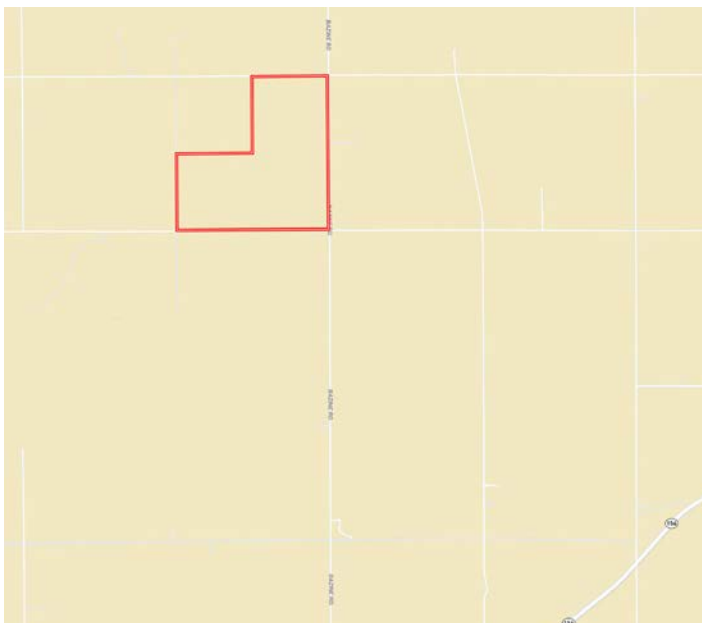

Soil Map



SOIL CODE	SOIL DESCRIPTION	ACRES	%	CPI	NCCPI	CAP
2756	Penden silty clay loam, 1 to 3 percent slopes	98.6	21.07	0	68	2e
2612	Harney silt loam, 0 to 1 percent slopes	76.08	16.25	0	70	2c
2724	Nibson-Wakeen loams, 3 to 20 percent slopes	72.13	15.41	0	36	6e
2613	Harney silt loam, 1 to 3 percent slopes	65.99	14.1	0	69	2e
2951	Wakeen silt loam, 1 to 3 percent slopes	36.34	7.76	0	48	3e
2757	Penden silty clay loam, 3 to 7 percent slopes	31.93	6.82	0	67	3e
2614	Harney silt loam, 3 to 7 percent slopes	29.57	6.32	0	68	3e
2232	Roxbury-Bridgeport complex, channeled, frequently flooded	21.29	4.55	0	47	3w
2762	Penden-Humbarger complex, 0 to 12 percent slopes	19.13	4.09	0	63	6e
1643	Kim-Penden silty clay loams, 3 to 6 percent slopes, eroded	16.14	3.45	0	54	4e
2953	Wakeen silt loam, 3 to 7 percent slopes	0.87	0.19	0	47	4e
TOTALS		468.07(*)	100%	-	60.24	3.11

Information provided was obtained from sources deemed reliable, but the broker makes no guarantees as to its accuracy. All prospective buyers are urged to inspect the property, its title and to rely on their own conclusions. Seller reserves the right to refuse any or all offers submitted and may withdraw the property from offering without notice. Farmers National Company and its representatives on the reverse side are the Designated Agents for the seller.