



Farmers
National
Company™

www.FarmersNational.com

L-2400453



SCAN THE QR CODE
FOR MORE INFO!



LAND FOR SALE

5.15± Acres, Holt County, Nebraska

OFFERED AT
\$50,000

Highlights:

- Potential new home site
- Close to U.S. Highway 281
- Recently surveyed



For additional information, please contact:

Dave Hickey, Agent | (402) 340-4436
DHickey@FarmersNational.com

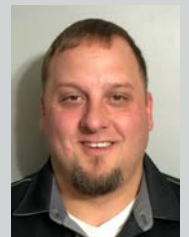

Bryan Hoefler, Agent | (402) 340-4685
BHoefler@FarmersNational.com

Property Information

Directions to Property: Five miles east of Chambers, Nebraska, along Highway 95, then three miles south on U.S. Highway 281 and ½ mile west of 851st Road.

Legal Description: An irregular tract of land located in the Southeast Quarter (SE¼) of Section 1, Township 25 North, Range 12 West of the 6th P.M., Holt County, Nebraska.

Property Description: 5.15+/- acres with lots of opportunity! Located just 7 miles southeast of Chambers and only ½ mile from U.S. Highway 281. Perfect spot for a new home, with plenty of trees along the north end of the property. Recently surveyed, plus electrical power close by. Small tracts like this are very hard to find! **Call the agents today!**

Taxes: \$90.84

Property Location

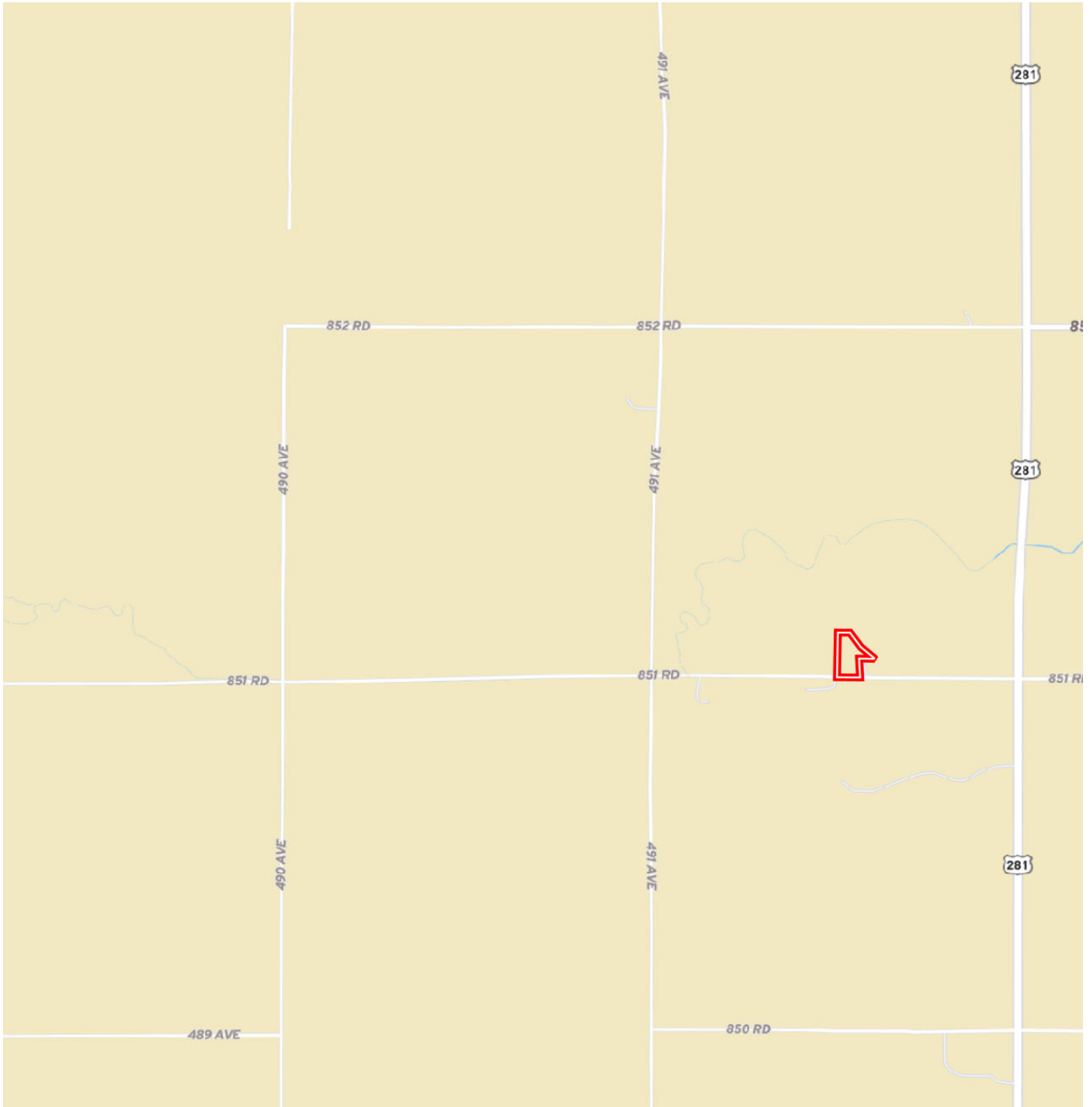

Aerial Map



Soil Map



SOIL CODE	SOIL DESCRIPTION	ACRES	%	CPI	NCCPI	CAP
4650	lpage loamy fine sand, 0 to 3 percent slopes	4.64	90.45	54	31	4e
4374	Libory-Whitelake loamy fine sands, 0 to 3 percent slopes	0.49	9.55	0	39	3e
TOTALS		5.13(*)	100%	48.84	31.76	3.9



Information provided was obtained from sources deemed reliable, but the broker makes no guarantees as to its accuracy. All prospective buyers are urged to inspect the property, its title and to rely on their own conclusions. Seller reserves the right to refuse any or all offers submitted and may withdraw the property from offering without notice. Farmers National Company and its representatives on the reverse side are the Designated Agents for the seller.

LAND FOR SALE

5.15± Acres, Holt County, Nebraska



**SCAN THE QR CODE
FOR MORE INFO!**



www.FarmersNational.com

Real Estate Sales • Farm and Ranch Management • Energy Management
Appraisals • Insurance • Consultations • Forestry Management • Hunting Lease Network • FNC Ag Stock