

L-2500191

Roseau County, Minnesota, 317 AC +/-

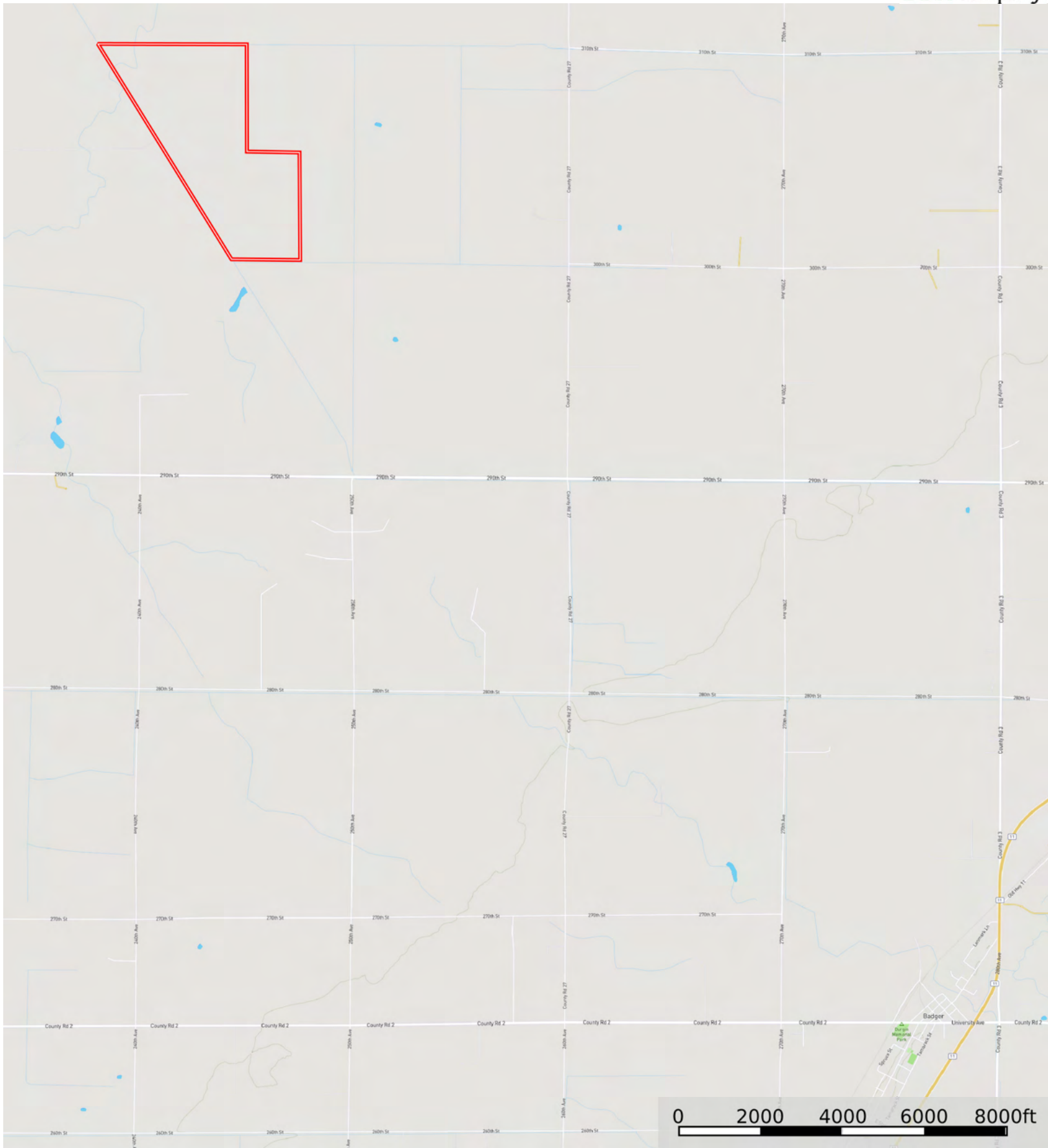

 Boundary

L-2500191

Roseau County, Minnesota, 317 AC +/-



0 500 1000 1500 2000ft

 Boundary



The information contained herein was obtained from sources deemed to be reliable. Land id™ Services makes no warranties or guarantees as to the completeness or accuracy thereof.

L-2500191

Roseau County, Minnesota, 317 AC +/-



 Boundary

Boundary 321.41 ac

SOIL CODE	SOIL DESCRIPTION	ACRES	%	CPI	NCCPI	CAP
I83A	Wildwood muck, dense till, 0 to 1 percent slopes	150.7 1	46.89	15	49	6w
I739A	Dora muck, 0 to 1 percent slopes	82.37	25.63	5	49	6w
I88A	Haug muck, 0 to 1 percent slopes	26.49	8.24	15	38	6w
I82A	Cathro muck, dense till, 0 to 1 percent slopes	20.43	6.36	15	53	6w
I741A	Boash clay loam, dense till, 0 to 1 percent slopes	18.99	5.91	88	51	2w
I127A	Percy loam, 0 to 1 percent slopes	11.52	3.58	85	41	2w
I81A	Northwood muck, dense till, 0 to 1 percent slopes	10.9	3.39	10	43	6w
TOTALS		321.4 1(*)	100%	19.09	47.98	5.62

(*) Total acres may differ in the second decimal compared to the sum of each acreage soil. This is due to a round error because we only show the acres of each soil with two decimal.

