

 Boundary

L-2600340

Holt County, Nebraska, 160 AC +/-

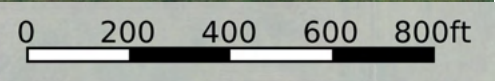

 Boundary

Boundary 159.81 ac

SOIL CODE	SOIL DESCRIPTION	ACRES	%	CPI	NCCPI	CAP
4249	Ord-Lute fine sandy loams, rarely flooded	65.19	40.79	0	40	2w
4560	Elsmere-lpage loamy fine sands, 0 to 3 percent slopes	53.17	33.27	0	33	4w
4646	lpage loamy fine sand, 0 to 3 percent slopes	18.19	11.38	54	31	4e
4576	Gannett loam, 0 to 1 percent slopes	14.31	8.95	51	34	5w
4871	Valentine-Dunday loamy fine sands, 0 to 3 percent slopes	8.95	5.6	0	34	4e
TOTALS		159.8 1(*)	100%	10.71	35.78	3.27

(*) Total acres may differ in the second decimal compared to the sum of each acreage soil. This is due to a round error because we only show the acres of each soil with two decimal.

Capability Legend

Increased Limitations and Hazards

Decreased Adaptability and Freedom of Choice Users

Land, Capability

	1	2	3	4	5	6	7	8
'Wild Life'	•	•	•	•	•	•	•	•
Forestry	•	•	•	•	•	•	•	
Limited	•	•	•	•	•	•	•	
Moderate	•	•	•	•	•	•		
Intense	•	•	•	•	•			
Limited	•	•	•	•				
Moderate	•	•	•					
Intense	•	•						
Very Intense	•							

Grazing Cultivation

(c) climatic limitations (e) susceptibility to erosion

(s) soil limitations within the rooting zone (w) excess of water

L-2600340

Holt County, Nebraska, 160 AC +/-

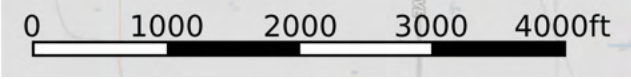
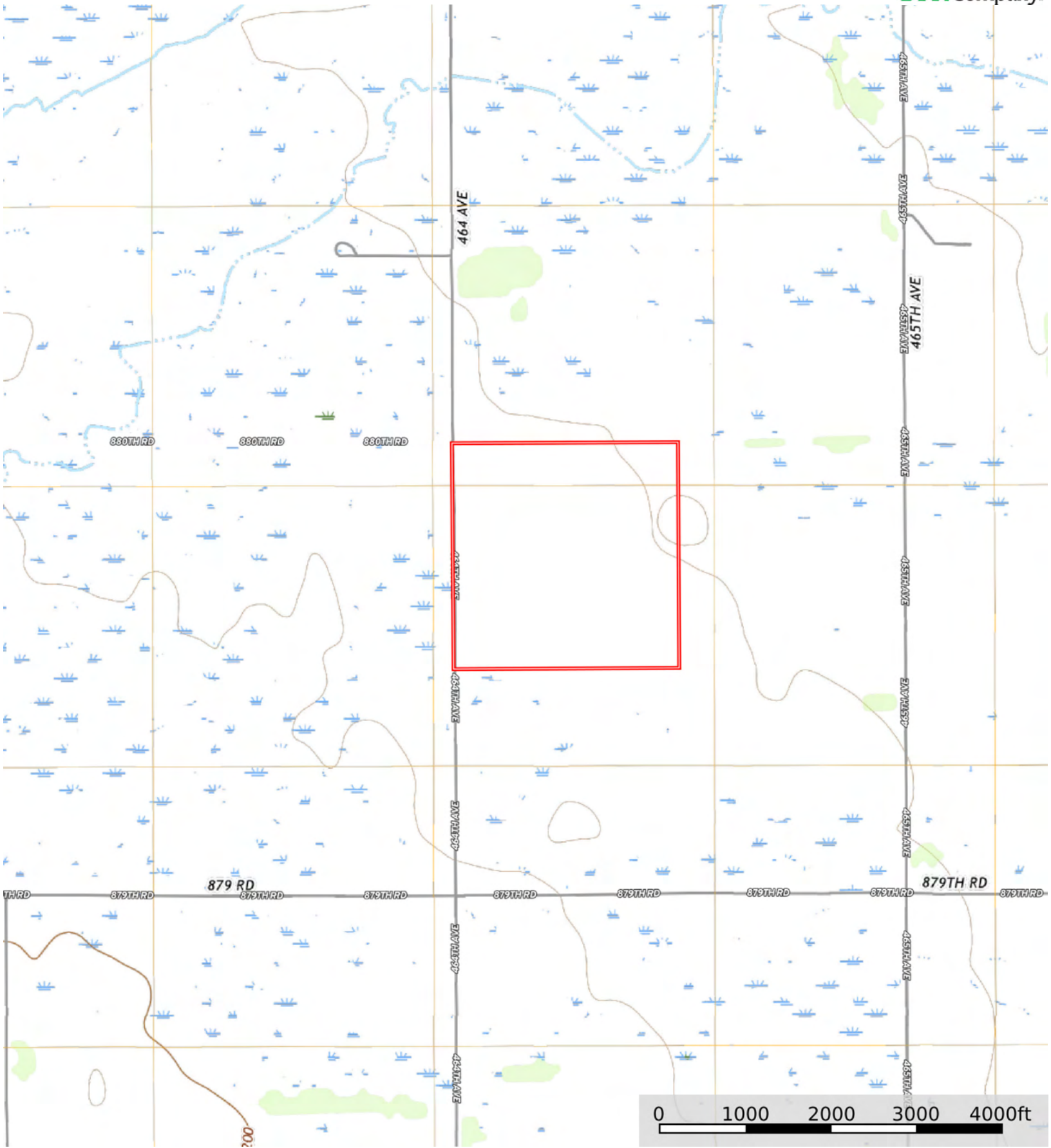

 Boundary