

Soils Map

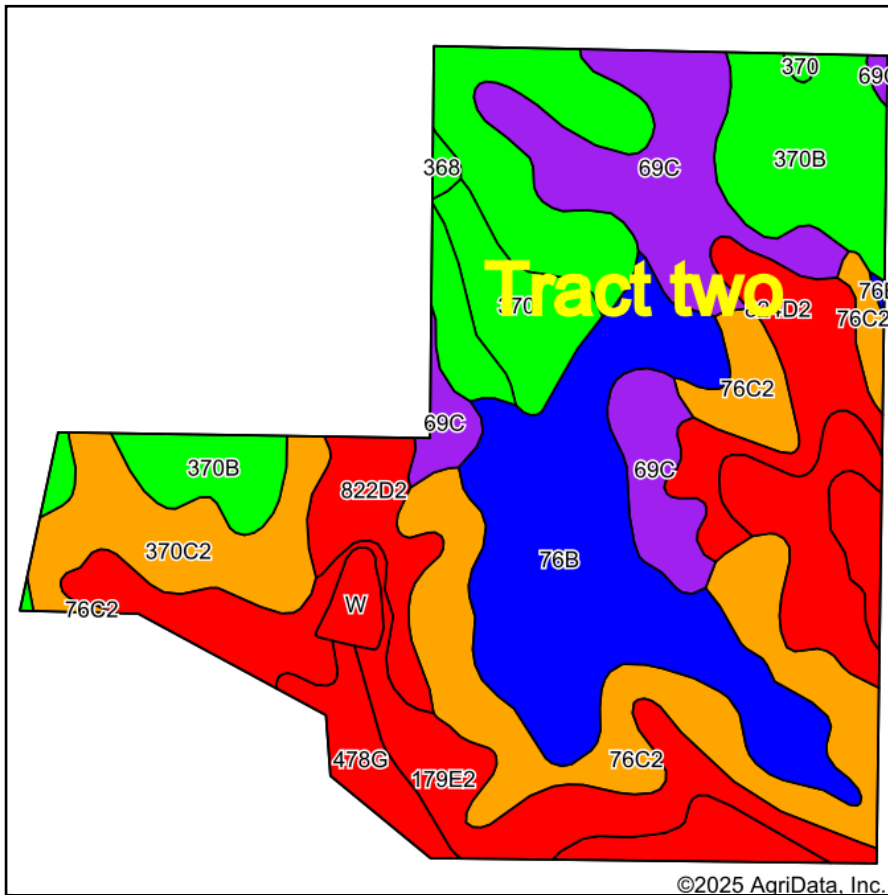

Soils data provided by USDA and NRCS.

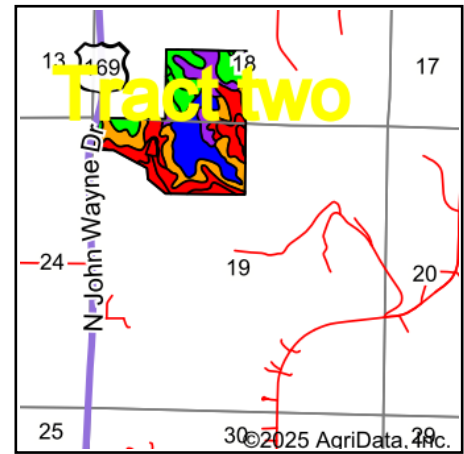

State: **Iowa**
 County: **Madison**
 Location: **19-76N-27W**
 Township: **Union**
 Acres: **112.97**
 Date: **8/28/2025**

Maps Provided By:

 CUSTOMIZED ONLINE MAPPING
 © AgriData, Inc. 2023 www.AgriDataInc.com



Area Symbol: IA121, Soil Area Version: 28					
Code	Soil Description	Acres	Percent of field	CSR2 Legend	CSR2**
76B	Ladoga silt loam, 2 to 5 percent slopes	19.44	17.2%		86
370B	Sharpsburg silty clay loam, 2 to 5 percent slopes	19.16	17.0%		91
76C2	Ladoga silt loam, dissected till plain, 5 to 9 percent slopes, eroded	16.41	14.5%		75
179E2	Gara loam, dissected till plain, 14 to 18 percent slopes, eroded	16.20	14.3%		32
69C	Clearfield silty clay loam, dissected till plain, 5 to 9 percent slopes	13.56	12.0%		59
370C2	Sharpsburg silty clay loam, 5 to 9 percent slopes, eroded	7.06	6.2%		80
478G	Steep rock land	6.16	5.5%		5
824D2	Shelby-Lamoni complex, 9 to 14 percent slopes, eroded	5.65	5.0%		28
370	Sharpsburg silty clay loam, 0 to 2 percent slopes	4.10	3.6%		96
822D2	Lamoni clay loam, 9 to 14 percent slopes, eroded	3.83	3.4%		7
W	Water	1.10	1.0%		0
368	Macksburg silty clay loam, 0 to 2 percent slopes	0.30	0.3%		93
Weighted Average					63.4

**IA has updated the CSR values for each county to CSR2.

Soils data provided by USDA and NRCS.