

Soils Map

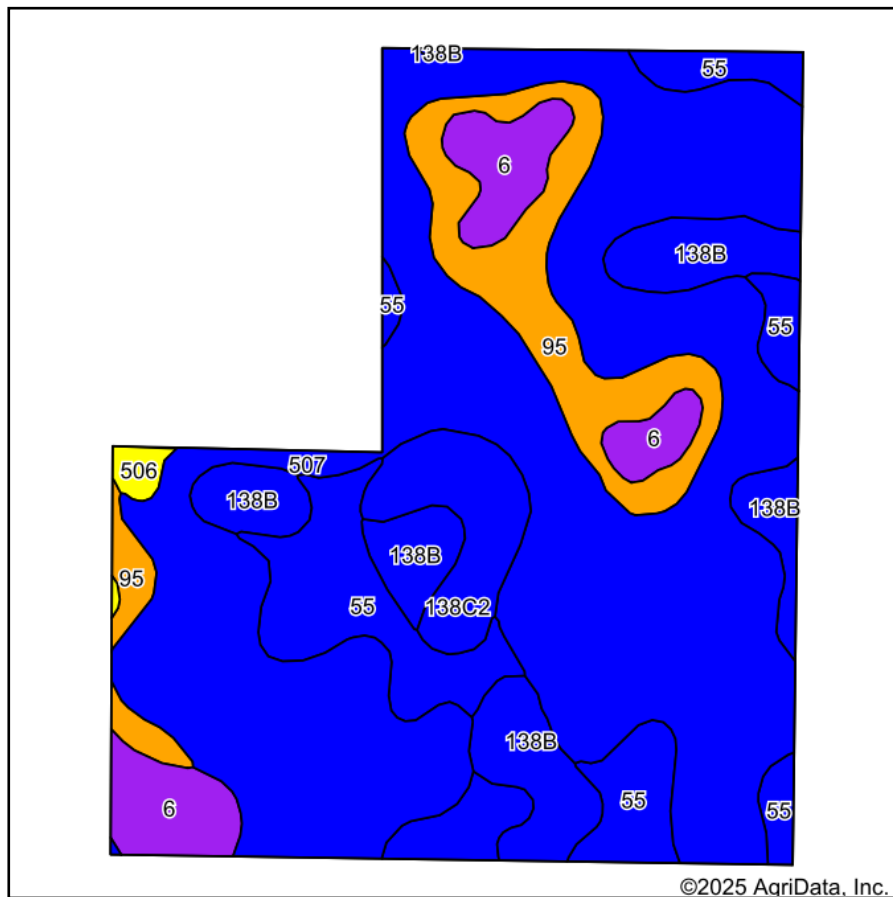

Soils data provided by USDA and NRCS.

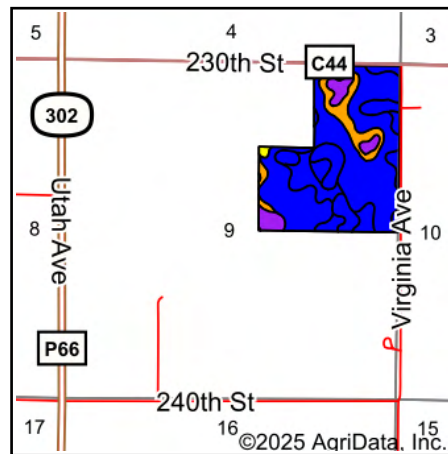

State: **Iowa**
 County: **Humboldt**
 Location: **9-91N-27W**
 Township: **Norway**
 Acres: **105.21**
 Date: **10/1/2025**



Maps Provided By:
surety
 CUSTOMIZED ONLINE MAPPING
 © AgriData, Inc. 2023 www.AgriDataInc.com



Area Symbol: IA091, Soil Area Version: 30

| Code | Soil Description | Acres | Percent of field | CSR2 Legend | Non-Irr Class *c | CSR2** | *n NCCPI Soybeans |
|------------------|---|-------|------------------|-------------|------------------|--------|-------------------|
| 507 | Canisteo clay loam, 0 to 2 percent slopes | 58.59 | 55.7% | | IIw | 84 | 81 |
| 55 | Nicollet clay loam, 1 to 3 percent slopes | 13.71 | 13.0% | | Iw | 89 | 81 |
| 138B | Clarion loam, 2 to 6 percent slopes | 10.90 | 10.4% | | Ile | 89 | 83 |
| 95 | Harps clay loam, 0 to 2 percent slopes | 10.14 | 9.6% | | IIw | 72 | 82 |
| 6 | Okoboji silty clay loam, 0 to 1 percent slopes | 6.62 | 6.3% | | IIIw | 59 | 74 |
| 138C2 | Clarion loam, 6 to 10 percent slopes, moderately eroded | 4.61 | 4.4% | | IIIe | 83 | 70 |
| 506 | Wacousta silty clay loam, depressional, 0 to 1 percent slopes | 0.64 | 0.6% | | IIIw | 69 | 79 |
| Weighted Average | | | | | 1.98 | 82.3 | *n 80.4 |

**IA has updated the CSR values for each county to CSR2.

*n: The aggregation method is "Weighted Average using all components"

*c: Using Capabilities Class Dominant Condition Aggregation Method