

Soils Map

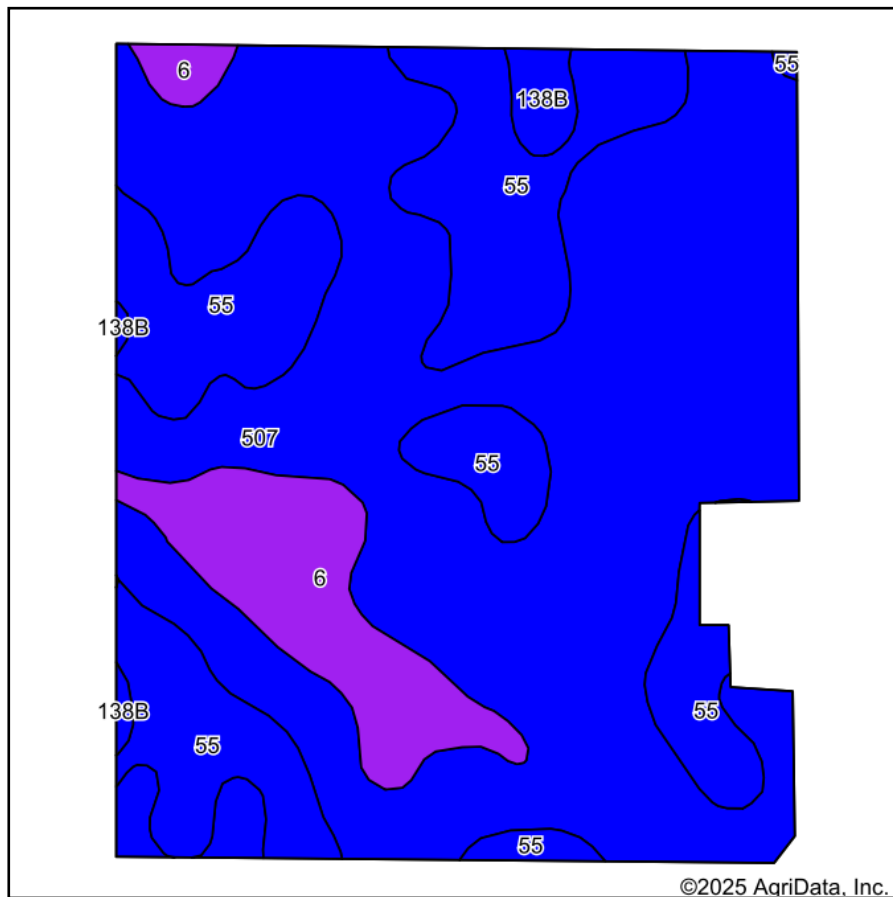

Soils data provided by USDA and NRCS.

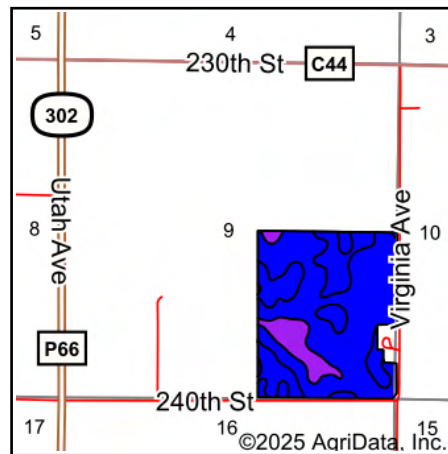

State: **Iowa**
 County: **Humboldt**
 Location: **9-91N-27W**
 Township: **Norway**
 Acres: **126.54**
 Date: **10/1/2025**



Maps Provided By:

 © AgriData, Inc. 2023 www.AgriDataInc.com



Area Symbol: IA091, Soil Area Version: 30							
Code	Soil Description	Acres	Percent of field	CSR2 Legend	Non-Irr Class *c	CSR2**	*n NCCPI Soybeans
507	Canisteo clay loam, 0 to 2 percent slopes	79.83	63.1%		Ilw	84	81
55	Nicollet clay loam, 1 to 3 percent slopes	32.88	26.0%		Iw	89	81
6	Okoboji silty clay loam, 0 to 1 percent slopes	12.00	9.5%		Illw	59	74
138B	Clarion loam, 2 to 6 percent slopes	1.83	1.4%		Ile	89	83
Weighted Average					1.83	83	*n 80.4

**IA has updated the CSR values for each county to CSR2.

*n: The aggregation method is "Weighted Average using all components"

*c: Using Capabilities Class Dominant Condition Aggregation Method