

# Soils Map

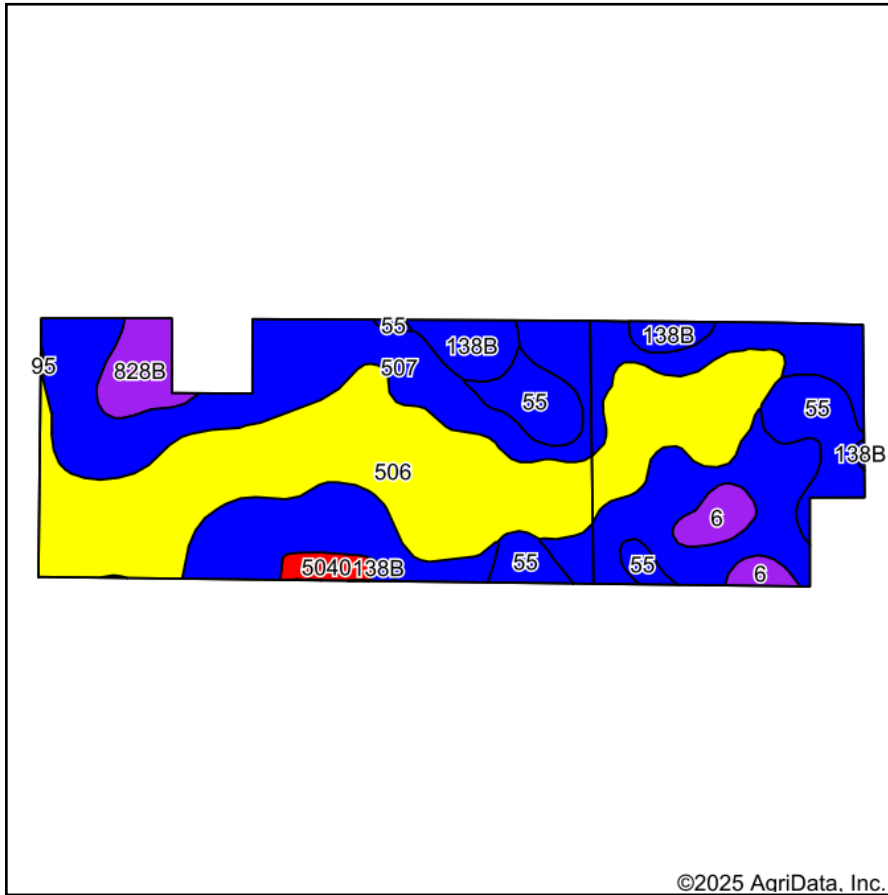

Soils data provided by USDA and NRCS.

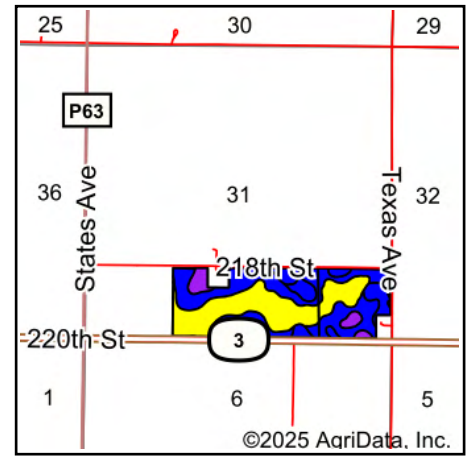

State: **Iowa**  
 County: **Humboldt**  
 Location: **31-92N-27W**  
 Township: **Lake**  
 Acres: **104.59**  
 Date: **12/19/2025**



Maps Provided By:



Area Symbol: IA091, Soil Area Version: 31							
Code	Soil Description	Acres	Percent of field	CSR2 Legend	Non-Irr Class *c	CSR2**	*n NCCPI Soybeans
507	Canisteo clay loam, 0 to 2 percent slopes	46.05	44.0%		IIw	84	81
506	Wacousta silty clay loam, depressional, 0 to 1 percent slopes	37.93	36.3%		IIIw	69	79
55	Nicollet clay loam, 1 to 3 percent slopes	9.77	9.3%		Iw	89	81
138B	Clarion loam, 2 to 6 percent slopes	3.84	3.7%		Ile	89	83
828B	Zenor sandy loam, 2 to 5 percent slopes	3.23	3.1%		IIIe	53	41
6	Okoboji silty clay loam, 0 to 1 percent slopes	2.55	2.4%		IIIw	59	74
5040	Udorthents, loamy (cut and fill land)	1.22	1.2%			5	
Weighted Average					*	76.7	*n 78

\*\*IA has updated the CSR values for each county to CSR2.

\*n: The aggregation method is "Weighted Average using all components"

\*c: Using Capabilities Class Dominant Condition Aggregation Method

\*- Non Irr Class weighted average cannot be calculated on the current soils data due to missing data.