

Soils Map

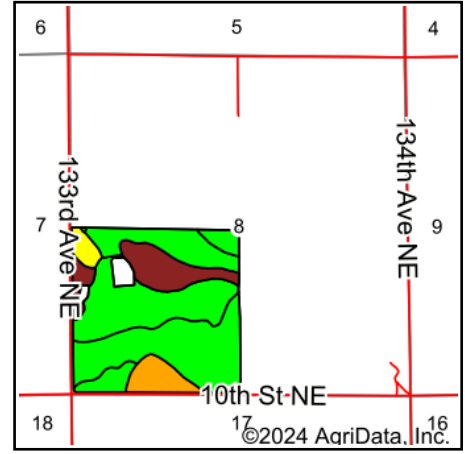

State: **North Dakota**
 County: **Steele**
 Location: **8-147N-55W**
 Township: **Golden Lake**
 Acres: **149.25**
 Date: **10/17/2024**

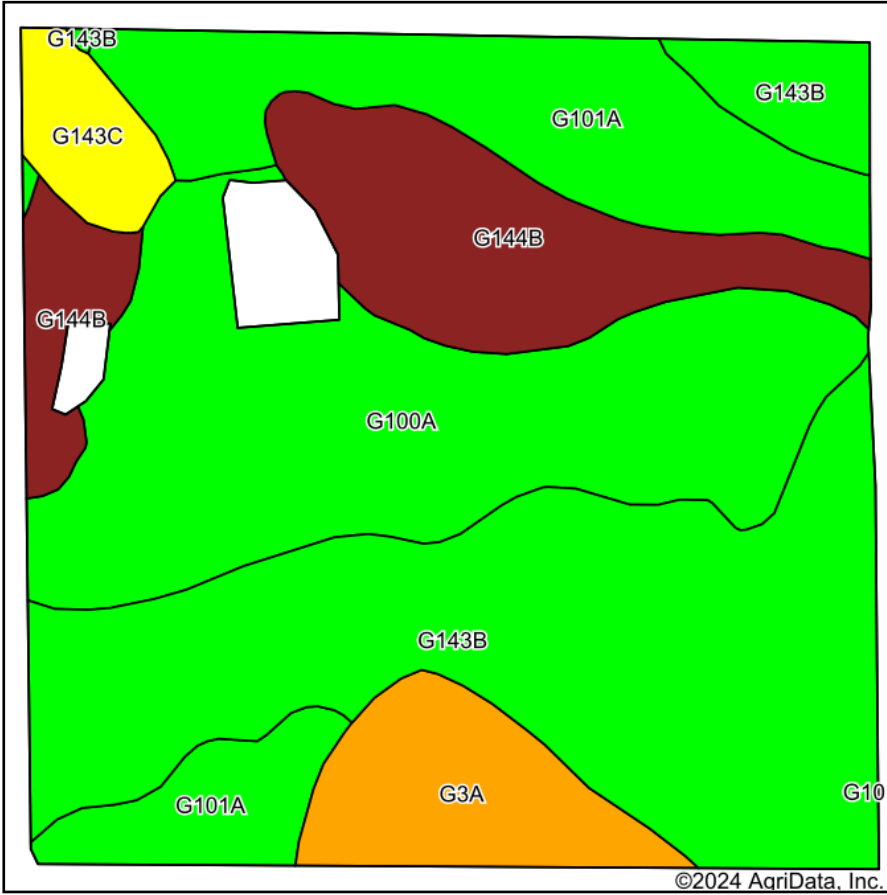

Maps Provided By:

 CUSTOMIZED ONLINE MAPPING
 © AgriData, Inc. 2023 www.AgriDataInc.com



Soils data provided by USDA and NRCS.

Area Symbol: ND091, Soil Area Version: 28

Code	Soil Description	Acres	Percent of field	Non-Irr Class Legend	Non-Irr Class *c	Productivity Index	*n NCCPI Soybeans
G143B	Barnes-Svea loams, 3 to 6 percent slopes	50.34	33.8%		Ile	75	58
G100A	Hamerly-Tonka complex, 0 to 3 percent slopes	38.59	25.9%		Ile	64	46
G101A	Hamerly-Wyard loams, 0 to 3 percent slopes	25.13	16.8%		Ile	77	57
G144B	Barnes-Buse loams, 3 to 6 percent slopes	20.64	13.8%		IIle	69	57
G3A	Parnell silty clay loam, 0 to 1 percent slopes	10.17	6.8%		Vw	25	14
G143C	Barnes-Buse-Langhei loams, 6 to 9 percent slopes	4.38	2.9%		IVe	55	53
Weighted Average					2.40	67.7	*n 51.4

*n: The aggregation method is "Weighted Average using all components"

*c: Using Capabilities Class Dominant Condition Aggregation Method