

Number: 2022-02170
Recorded: 5/3/2022 at 8:25:01.0 AM
County Recording Fee: \$67.00
Iowa E-Filing Fee: \$3.00
Combined Fee: \$70.00
Revenue Tax:
Lindsay Laufersweiler RECORDER
Webster County, Iowa

**EASEMENT AGREEMENT
Recorder's Cover Sheet**

Preparer Information: Jennifer Hodge Burkett
111 East Grand Avenue, Suite 301
Des Moines, IA 50309
(515) 242-8906

Taxpayer Information: N/A

Return Document To: Summit Carbon Solutions, LLC
111 East Grand Avenue, Suite 301
Des Moines, IA 50309
(515) 242-8906

Grantor: Gary L. Knopf, a single person

Grantee: Summit Carbon Solutions, LLC

Legal Description: See Exhibit A and Exhibit B

Document or instrument number of previously recorded documents: N/A



EASEMENT AGREEMENT

This easement agreement ("Agreement") is made as of the date of the last Landowner signature to the Agreement (the "Effective Date") by and between **Gary L. Knopf, a single person**, whose mailing address is set forth below, (hereinafter referred to as "Landowner", whether one or more), and **Summit Carbon Solutions, LLC**, a Delaware limited liability company, whose mailing address is 2321 North Loop Drive, Suite 221, Ames, IA 50010, and its successors and assigns (such entity and its successors and assigns are collectively referred to as the "Company"). For the consideration of TEN AND No/100 Dollars (\$10.00) and other good and valuable consideration, the receipt and sufficiency of which are hereby acknowledged, the parties agree as follows:

1. **Grant.** Landowner owns the real property described on the attached Exhibit A ("Landowner's Property") and hereby grants, sells and conveys unto Company, for use by Company and its agents, employees, designees, contractors, guests, invitees, successors and assigns, and all those acting by or on behalf of it, the following easements in, over, through, across, under, and along Landowner's Property, in the approximate locations shown on the attached and incorporated Exhibit B, except as noted below:
 - a. **Pipeline Easement.** A free and unobstructed permanent, non-exclusive pipeline easement fifty feet (50') in width ("Pipeline Easement"), for the purposes of owning, accessing, surveying, establishing, laying, constructing, reconstructing, installing, realigning, modifying, replacing, improving, substituting, operating, inspecting, maintaining, repairing, patrolling, protecting, changing slopes of cuts and fills to ensure proper lateral and subjacent support for and drainage for, changing the size of, relocating and changing the route or routes of, abandoning in place and removing at will, in whole or in part, one pipeline not to exceed twenty-four inches (24") in nominal diameter for the transportation of carbon dioxide and its naturally occurring constituents and associated substances and any appurtenant facilities above or below ground, including aerial markers, power drops, telecommunications, cathodic protection, and such other equipment as is used or useful for the foregoing purposes, (collectively, the "Pipeline Facilities").
 - b. **Temporary Easement.** For the period beginning on the Effective Date and terminating on the Company's delivery to Landowner of written notice of termination, which Company shall deliver within a reasonable time after completion of construction on the Landowner's Property, a free and unobstructed non-exclusive temporary construction easement (the "Temporary Construction Easement") for the purpose of accessing, surveying, establishing, laying, constructing, reconstructing, installing, realigning, modifying, replacing, improving, substituting, operating, inspecting, maintaining, repairing, patrolling, protecting, changing slopes of cuts and fills to ensure proper lateral and subjacent support for and drainage for, changing the size of, relocating and changing the route or routes of, abandoning in place and removing at will, in whole or in part the Pipeline Facilities in the Pipeline Easement.
 - c. **Access Easement.** A free and unobstructed non-exclusive easement in, to, through, on, over, under, and across the Landowner's Property and over the property of Landowner adjacent to the Easement and lying between public or private roads and the Easement (the "Access Easement") for the purpose of ingress and egress to the Pipeline Easement and, while in effect, Temporary Construction Easement and for all purposes necessary and at all times convenient to exercise the rights granted to it by this Agreement. Access Easement may not be specifically shown on Exhibit B.



The Pipeline Easement, Temporary Construction Easement and Access Easement may be collectively referred to in this Agreement as the "Easements".

2. **Location.** Exhibit B shows the approximate location of the Pipeline Easement and Temporary Construction Easement and may show portions of the Access Easement. Company shall have the right to select the exact location of the Easements and the location of the pipeline and other Pipeline Facilities within the Pipeline Easement, such that the centerline of the pipeline may not, in all instances, lie in the middle of the Pipeline Easement. The parties acknowledge that Exhibit B may be attached to this Agreement in preliminary form, whether as sketches or surveys or otherwise. Accordingly, the parties agree that upon completion of a more complete depiction of the locations of the Easements, the Company, without joinder of Landowner, may replace Exhibit B with Exhibit B-1, which shall be such final, more complete exhibit, by affidavit, amendment or otherwise. However, upon the request of Company, Landowner agrees to cooperate with Company and to execute and deliver to Company any additional documents, including an amendment to this Agreement, for the purpose correcting the legal description or location of the Easements or making such other modifications requested by Company to accomplish the purposes of this Agreement. Company shall provide Landowner with a copy of the recorded affidavit, amendment or re-recorded Agreement.
3. **Damages.** Company agrees to pay to Landowner the sums set forth on the Damage Calculation Sheet dated with the Effective Date in satisfaction of those damages described on the Damage Calculation Sheet. For any claimed damages not addressed in the Damage Calculation Sheet that are directly caused by Company's construction or use of the Easements, the parties will comply with the requirements and procedure set forth in Iowa Code §§ 479B.29 and 479B.30.
4. **Restoration.** After it has exercised its rights to use the Easements in any manner that disturbs the surface of the Easements, Company will, insofar as reasonably practicable and except as the surface may be permanently modified in accordance with the rights granted under this Agreement, restore the ground disturbed by the Company's use of the Easements and will construct and maintain soil conservation devices on the Pipeline Easement as may be reasonably required to prevent damage to the property of Landowner from soil erosion resulting from operations of Company under this Agreement. Company shall restore all fences to as nearly as reasonably practicable to their condition prior to the use of said Easements, except for any portion within the Easements that is permanently altered in accordance with rights given under this Agreement. If Landowner notifies Company that any drainage tile or irrigation systems on the Grantor's Property have been damaged as a direct result of Company's activities in connection with the Easements, then Company shall, at Landowner's option, repair or replace such tile or irrigation or pay Landowner the costs to repair or replace such tile or irrigation.
5. **Landowner's Use.**
 - a. Subject to the following subsections, Landowner may use the Pipeline Easement and Access Easement for any and all purposes not inconsistent with the purposes set forth in this Agreement. Landowner's uses may include but shall not be limited to agricultural, open space, and installation and maintenance of fences (provided Company shall at all times have access through any such fence by means of a gate), provided that any such use is not otherwise prohibited by applicable law and provided that such use does not, in Company's sole discretion, cause a safety hazard or unreasonably interfere with Company's rights under this Agreement. The use of the Pipeline Easement by Landowner shall be regulated by all appropriate ordinances, regulations, resolutions or laws of the governmental entity with authority over the Pipeline Easement.



- b. Landowner may not use any part of the Easements in a way that may damage, destroy, injure, and/or interfere with the Company's right to use said Easements for the purposes set forth in this Agreement. Without limiting the generality of the previous statement, Landowner is not permitted to conduct any of the following activities on the Easements without the written permission of Company: (1) construct or permit the construction or installation of any temporary or permanent building or site improvements; (2) drill or operate any well or any equipment for the production or development of minerals; (3) remove soil or change the grade or slope; (4) impound surface water; or (5) plant trees or landscaping. Landowner further agrees that no above or below ground obstruction, whether temporary or permanent, man-made or natural, that, in the sole discretion of Company, may endanger or interfere with the efficiency, safety, or convenient operation of the pipeline and other Pipeline Facilities or use of the Easements may be placed, erected, installed or permitted to exist without the written permission of Company. In the event the terms of this paragraph are violated, Landowner shall immediately remove such violation upon receipt of written notice from Company or Company shall have the immediate right to correct or remove such violation at the sole expense of Landowner. Landowner shall promptly reimburse Company for any actual expense related to such correction or removal. Any improvements, whether above or below ground, temporary or permanent, installed by Landowner subsequent to the date that Company acquires possession of the Easements, may be removed by Company without liability to Landowner for damages.
- c. Landowner acknowledges and agrees that during the initial construction of the Pipeline Facilities or any construction, maintenance, repair, replacement or removal work on the Pipeline Facilities, Landowner may not have use of the Easements for any purpose so as to avoid disrupting such construction or other work or compromising the safety considerations of the construction or repair work. Landowner agrees to abide by any and all safety instructions established by the Company.
6. **Indemnification.** Company agrees to indemnify and hold Landowner harmless from and against any claim or liability or loss from personal injury or property damage resulting from or arising out of the use of the Easements by Company, its servants, agents or invitees, excepting, however, such claims, liabilities or damages as may be due to or caused by the acts of Landowner, or its servants, agents or invitees.
7. **Assignment.** Company shall have the right to sell, assign, apportion, mortgage or lease this Agreement, as amended from time to time, and the Easements granted under it, in whole or in part, to one or more parties, and Company shall be released from its obligations under this Agreement to the extent of such sale, assignment, apportionment, or lease, provided that any such purchaser, assignee, apportionee, or lessee assumes Company's obligations. The Pipeline Easement and Access Easement shall be permanent, and the Easements and provisions of this Agreement, including all benefits and burdens, shall run with the land.
8. **Landowner's Interest.** Landowner, for itself, its heirs, successors, and assigns, represents, warrants, and covenants that it is the sole true and lawful owner(s) of Landowner's Property and has full right and power to grant and convey the Easements. Landowner hereby binds itself and its heirs, assigns, devisees, successors, and legal representatives to warrant and forever defend the above-described Easements and rights, unto Company, and Company's successors and assigns, against every person whomsoever lawfully claiming or to claim the same, or any part thereof. Landowner relinquishes, releases and waives all rights of dower, homestead and distributive shares in and to the Easements.

9. **Landowner Liens.** Landowner consents to Company contacting any lender, mortgagee, or other pre-existing holder of a lien or interest in the Property in order to secure a consent, subordination, non-disturbance agreement or such other document as Company deems necessary for the benefit of the parties. Such form may be recorded in the real estate records of the county in which Landowner's Property lies. Upon the request of Company, Landowner agrees to fully cooperate with Company in order to secure such document from each lender, mortgagee, or other pre-existing holder of a lien or interest in the Property. Landowner shall not be required to incur any third party out of pocket expenses in connection with assisting Company in the pursuit of the foregoing documents; all such third party out of pocket expenses relating to the same shall be paid by Company.
10. **Property of Company.** Notwithstanding any rule of law or equity, unless otherwise sold, bartered or conveyed to another party, the pipeline and all other Pipeline Facilities shall at all times remain the property of the Company notwithstanding that the pipeline or those facilities may be annexed or affixed to the freehold or abandoned in place by Company.
11. **Miscellaneous.**
 - a. To the extent provisions included in the attached and incorporated Exhibit C, if any, conflict with provisions of this Agreement, provisions of Exhibit C control.
 - b. All notices given or permitted to be given under this Agreement shall be in writing. Notice is considered given either (i) when delivered in person to the recipient named above, (ii) upon deposit in the United States mail in a sealed envelope or container, postal charges prepaid, return receipt requested or certified mail, or (iii) upon deposit with an overnight courier service. Either party may, by notice given at any time, require subsequent notices to be given to another individual person, whether a party or an officer or representative, or to a different address, or both.
 - c. This Agreement and the Easements granted under it shall be interpreted in accordance with the laws of the State of Iowa and all applicable federal laws.
 - d. Company may exercise all or any of its rights in this Agreement at any time, and Company's non-use or limited use of any such rights shall not constitute forfeiture of or otherwise limit any such rights.
 - e. The waiver or failure to enforce any provision of this Agreement by either Landowner or Company or the waiver of a breach or violation of any provision of this Agreement by either party shall not operate as or be construed as a waiver of any subsequent breach, or waiver or failure to enforce, of any provision of this Agreement.
 - f. This Agreement may be signed in counterparts and all such counterparts shall be deemed as originals and binding upon each party executing any counterpart and upon its respective heirs, devisees, representatives, successors and assigns. Company's payment of consideration for this Agreement is evidence of Company's acceptance of the Agreement. This Agreement, or a memorandum giving notice of this Agreement, and exhibits, including subsequent Exhibit B-1, may be recorded in the real estate records of the county or counties where Landowner's Property lies.
 - g. This Agreement, including all exhibits, addendums and amendments to the Agreement, and any payment or damage calculation sheets provided to the Landowner, the required



notice of cancellation under Iowa Code chapter 479B (receipt of which in duplicate is hereby acknowledged) and any other documents signed contemporaneously with this Agreement, contain the entire agreement between the parties and there are not any other representations or statements, verbal or written that have been made modifying, adding to, or changing the terms of this Agreement.

- h. If any provision of this Agreement is invalid under any applicable statute or is declared invalid by a court of competent jurisdiction, then that provision shall be deemed to be severed from this Agreement and the remainder of this Agreement shall continue in full force and effect and shall be construed to the furthest extent legally possible so as to accomplish the purposes set forth in this Agreement.

Signature page(s) follows

A handwritten mark or signature, possibly a stylized 'L' or a similar symbol, located in the bottom right corner of the page.

Signature page to Easement Agreement

Gary L Knopf

GARY L. KNOPF

117 Main Street
Lehigh, IA 50557

Date: 3.31.22

ACKNOWLEDGMENT

State of IOWA)
)ss
County of WEBSTER)

This record was acknowledged before me on the 31ST day of MARCH, 2022, by Gary L Knopf, a single person.

Danny L. Steinbach
Notary Public

My Commission Expires: 2/04/2023

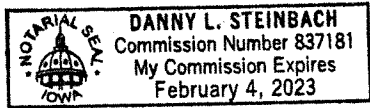


EXHIBIT "A"

IA-WE-302-0140.000, IA-WE-302-0142.000

Township 87 North, Range 28 West
Section 25: NE less part of E2NE (5.18 acres)

Being more particularly described in a Warranty Deed dated May 1, 2003 from Walter Entgelmeier and Joyce Entgelmeier, husband and wife; Harold Entgelmeier and Joyce Entgelmeier, husband and wife; Elizabeth Allard and Robert Allard, wife and husband; and Helen Lande and Willis Lande, wife and husband, to Gary L. Knopf recorded in Instrument Number 2003-03859 in the Recorders Office of Webster County, Iowa, less and except any conveyances heretofore made.

IA-WE-302-0146.000

Township 87 North Range 28 West
Section 24: E/2NE

Being more particularly described in a Warranty Deed dated October 28th, 1998 from L&R Ott Farms, Inc, a corporation organized and existing under the laws of Iowa to Gary L. Knopf, recorded as Book 241, Page 12 in the office of the Clerk and Recorder of Webster County, Iowa, less and except any conveyances heretofore made.

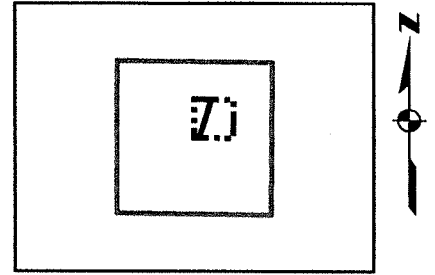
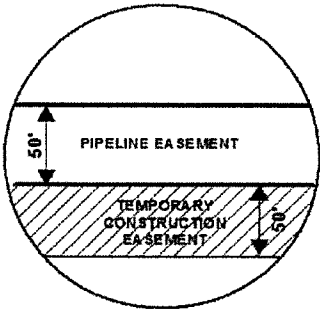
IA-WE-302-0150.000

Township 87 North, Range 27 West
Section 18: Part of SWfr4 lying East of the Road

Being more particularly described in that certain Warranty Deed dated March 23, 1988 from Dr. Charles A. Thomas, a/k/a Charles Allan Thomas and Leesanne Thomas, husband and wife to Gary L. Knopf, recorded in Book 222, Page 507, Document No. 3020, in the office of the Clerk and Recorder of Webster County, Iowa, less and except any conveyances heretofore made.

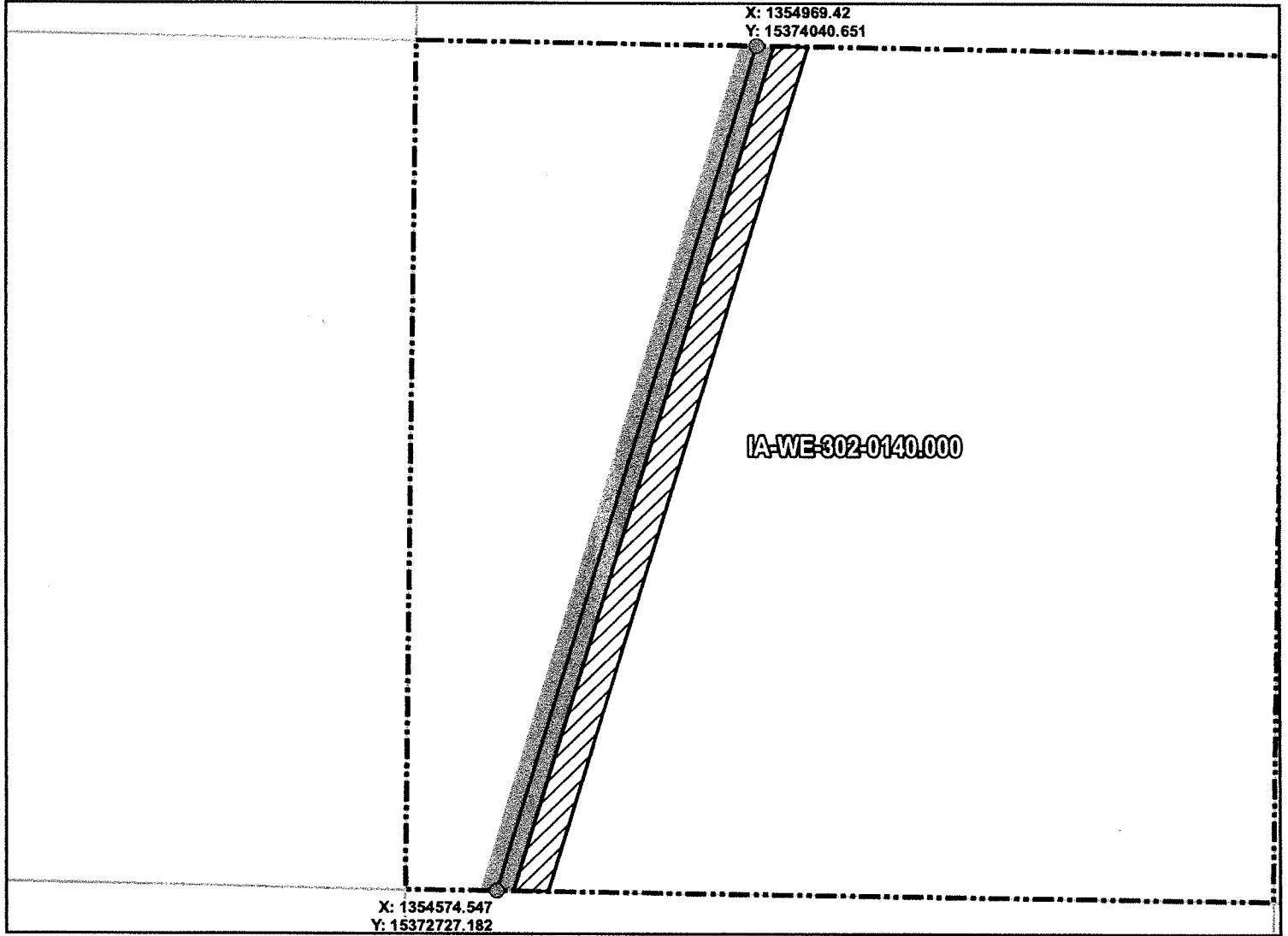


EXHIBIT "B" PROPOSED ROUTE WEBSTER COUNTY, IOWA



VICINITY MAP
N.T.S.

SEC. 25 T87N R28W



ROUTING LENGTH = 1371.54 FT
IMPACTS: PIPELINE EASEMENT = 1.574 AC. / TEMPORARY CONSTRUCTION EASEMENT = 1.574 AC.

Legend

PROPOSED ROUTE	PIPELINE EASEMENT
ROADS	TEMPORARY CONSTRUCTION EASEMENT
PARCEL BOUNDARY	SECTION BOUNDARY
ADJACENT PROPERTIES	COUNTY BOUNDARY

NOTES:

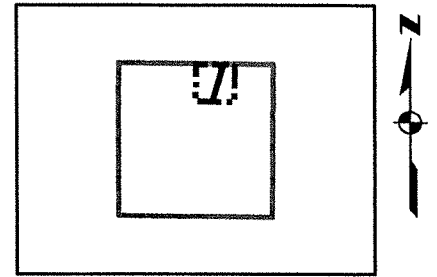
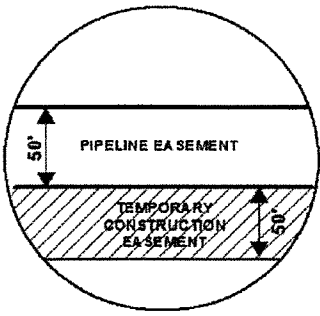
1. THIS IS A PRELIMINARY DOCUMENT AND IS INTENDED TO DEPICT THE APPROXIMATE LOCATION OF A PROPOSED PIPELINE EASEMENT.
2. THIS DOCUMENT DOES NOT REPRESENT A LAND SURVEY AND IS NOT INTENDED TO DEPICT THE FINAL ALIGNMENT
3. COORDINATE SYSTEM: UTM ZONE 15 NORTH, NAD83, US SURVEY FEET

SIGNATURE: *Gary L. Knopf* DATE: 3/2/22



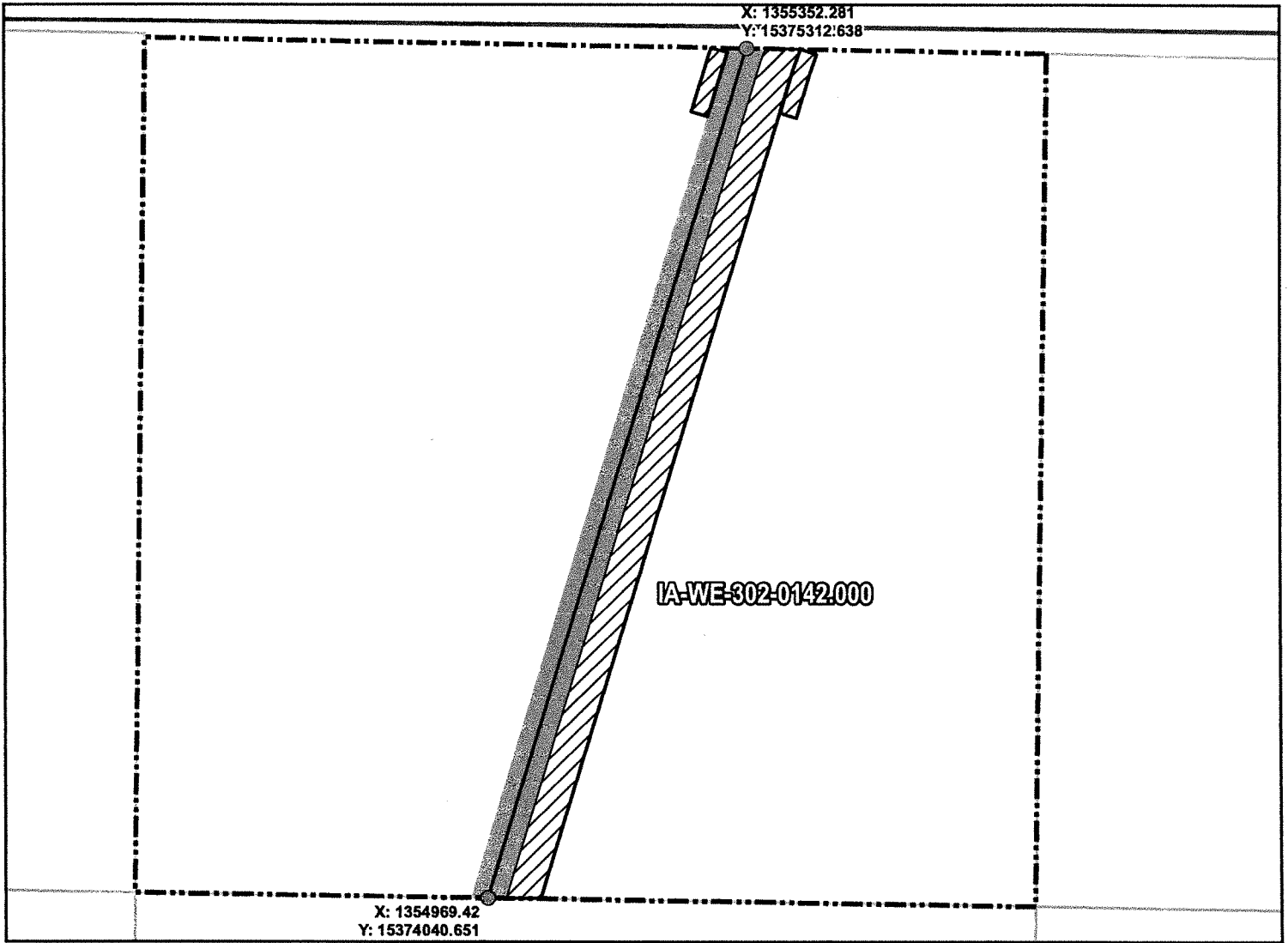
PROPOSED PIPELINE ROUTE		
DRAWN BY:	TRC	SUMMIT CARBON SOLUTIONS MIDWEST CARBON EXPRESS GARY L. KNOPF TAX ID: 1525200002 TRACT NUMBER: IA-WE-302-0140.000
CHECKED BY:	TRC	
MAP DATE:	10/29/2021	
SCALE:	1 inch = 249'	
REV NO.	DATE	DESCRIPTION
A	11/1/2021	INITIAL ISSUE
B	3/2/2022	REVISED ROUTE
DRAWING NO. BW-MCE-ACQ-IA-WE-302-0140.000		PROJECT NO. 450959 SHEET NO. 01 of 01

EXHIBIT "B" PROPOSED ROUTE WEBSTER COUNTY, IOWA



VICINITY MAP
N.T.S.

SEC. 25 T87N R28W



ROUTING LENGTH = 1328.368 FT
IMPACTS: PIPELINE EASEMENT = 1.525 AC. / TEMPORARY CONSTRUCTION EASEMENT = 1.64 AC.

- Legend**
- PROPOSED ROUTE
 - ROADS
 - ▭ PARCEL BOUNDARY
 - ▭ ADJACENT PROPERTIES
 - ▨ PIPELINE EASEMENT
 - ▨ TEMPORARY CONSTRUCTION EASEMENT
 - ▭ SECTION BOUNDARY
 - ▭ COUNTY BOUNDARY

NOTES:

1. THIS IS A PRELIMINARY DOCUMENT AND IS INTENDED TO DEPICT THE APPROXIMATE LOCATION OF A PROPOSED PIPELINE EASEMENT.
2. THIS DOCUMENT DOES NOT REPRESENT A LAND SURVEY AND IS NOT INTENDED TO DEPICT THE FINAL ALIGNMENT
3. COORDINATE SYSTEM: UTM ZONE 15 NORTH, NAD83, US SURVEY FEET

SIGNATURE: *[Signature]* DATE: 3/31/22



SUMMIT CARBON
SOLUTIONS

PROPOSED PIPELINE ROUTE

DRAWN BY: TRC
CHECKED BY: TRC
MAP DATE: 10/29/2021
SCALE: 1 inch = 242'

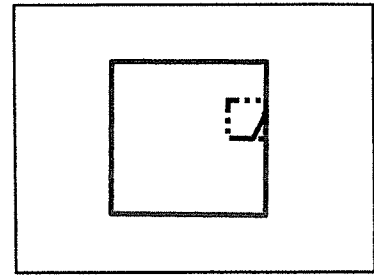
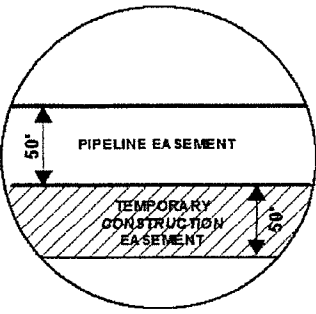
SUMMIT CARBON SOLUTIONS
MIDWEST CARBON EXPRESS
GARY L. KNOPF
TAX ID: 1525200001
TRACT NUMBER: IA-WE-302-0142.000

REV NO.	DATE	DESCRIPTION
A	11/1/2021	INITIAL ISSUE
B	3/2/2022	REVISED ROUTE

DRAWING NO. BW-MCE-ACQ-IA-WE-302-0142.000

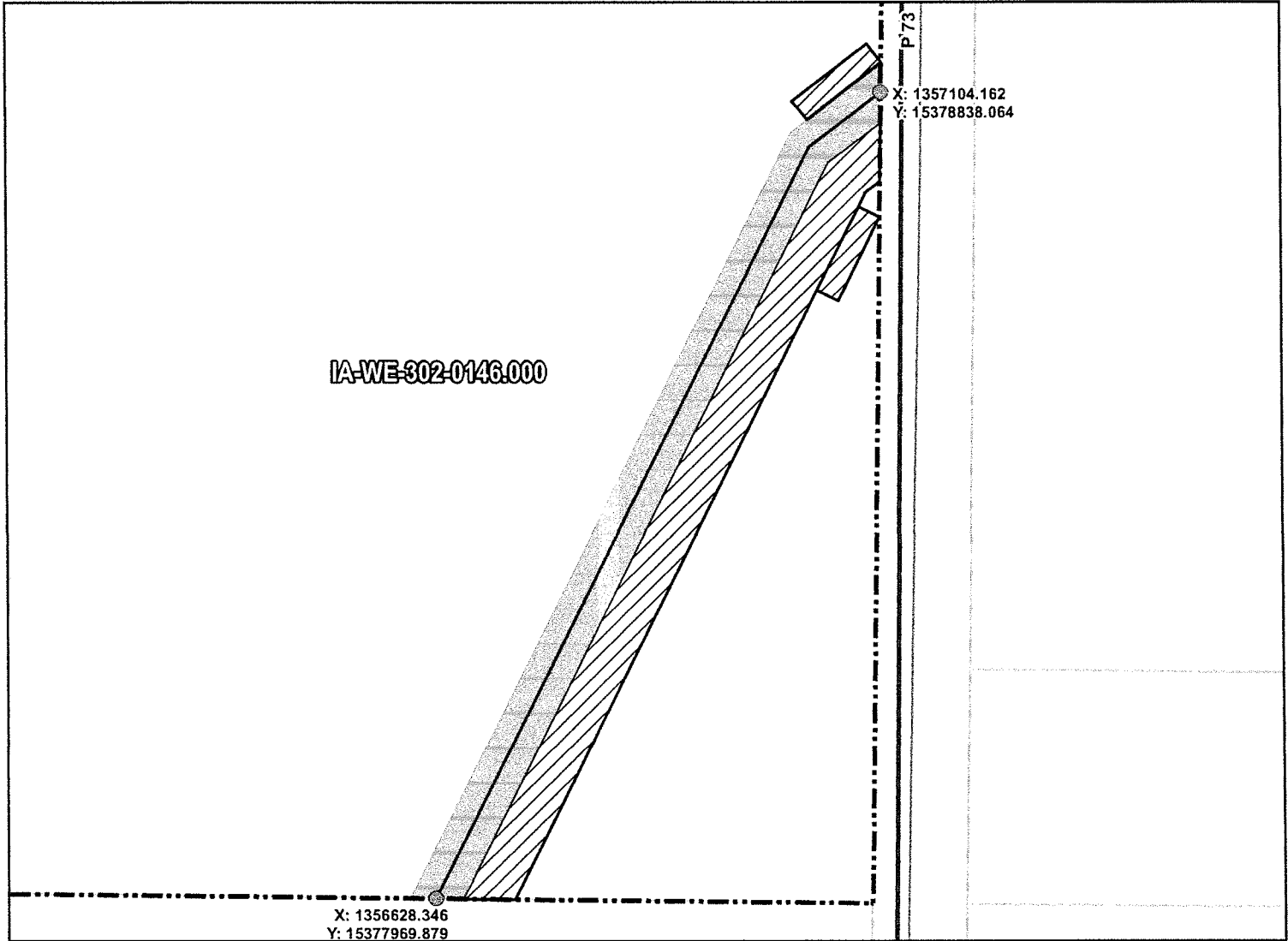
PROJECT NO. 450959 SHEET NO. 01 of 01

EXHIBIT "B" PROPOSED ROUTE WEBSTER COUNTY, IOWA



VICINITY MAP
N.T.S.

SEC. 24 T87N R28W



ROUTING LENGTH = 998.9 FT
IMPACTS: PIPELINE EASEMENT = 1.147 AC. / TEMPORARY CONSTRUCTION EASEMENT = 1.163 AC.

PROPOSED ROUTE	PIPELINE EASEMENT
PARCEL BOUNDARY	TEMPORARY CONSTRUCTION EASEMENT
ADJACENT PROPERTIES	SECTION BOUNDARY
	COUNTY BOUNDARY

NOTES:

1. THIS IS A PRELIMINARY DOCUMENT AND IS INTENDED TO DEPICT THE APPROXIMATE LOCATION OF A PROPOSED PIPELINE EASEMENT.
2. THIS DOCUMENT DOES NOT REPRESENT A LAND SURVEY AND IS NOT INTENDED TO DEPICT THE FINAL ALIGNMENT
3. COORDINATE SYSTEM: UTM ZONE 15 NORTH, NAD83, US SURVEY FEET

SIGNATURE: *Gary L. Knopf* DATE: 3/2/22



**SUMMIT CARBON
SOLUTIONS**

PROPOSED PIPELINE ROUTE

DRAWN BY: TRC
 CHECKED BY: TRC
 MAP DATE: 10/29/2021

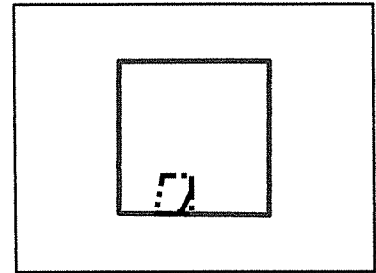
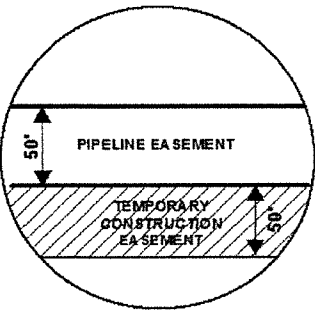
**SUMMIT CARBON SOLUTIONS
MIDWEST CARBON EXPRESS
GARY L. KNOPF**

TAX ID: 1524200005
TRACT NUMBER: IA-WE-302-0146.000

REV NO.	DATE	DESCRIPTION
A	11/1/2021	INITIAL ISSUE
B	3/10/2022	REVISED WORKSPACE

DRAWING NO. BW-MCE-ACQ-IA-WE-302-0146.000	PROJECT NO. 450959	SHEET NO. 01 of 01
---	--------------------	--------------------

EXHIBIT "B" PROPOSED ROUTE WEBSTER COUNTY, IOWA



VICINITY MAP
N.T.S.

SEC. 18 T87N R27W

IA-WE-302-0150.000

X: 1359611.953
Y: 15381479.984

X: 1359201.827
Y: 15380615.592

320TH ST 310TH ST

ROUTING LENGTH = 958.575 FT

IMPACTS: PIPELINE EASEMENT = 1.101 AC. / TEMPORARY CONSTRUCTION EASEMENT = 1.076 AC.

Legend

- PROPOSED ROUTE
- PARCEL BOUNDARY
- ADJACENT PROPERTIES
- PIPELINE EASEMENT
- TEMPORARY CONSTRUCTION EASEMENT
- SECTION BOUNDARY
- COUNTY BOUNDARY

NOTES:

1. THIS IS A PRELIMINARY DOCUMENT AND IS INTENDED TO DEPICT THE APPROXIMATE LOCATION OF A PROPOSED PIPELINE EASEMENT.
2. THIS DOCUMENT DOES NOT REPRESENT A LAND SURVEY AND IS NOT INTENDED TO DEPICT THE FINAL ALIGNMENT
3. COORDINATE SYSTEM: UTM ZONE 15 NORTH, NAD83, US SURVEY FEET

SIGNATURE: DATE: 3/31/22



SUMMIT CARBON SOLUTIONS

PROPOSED PIPELINE ROUTE

DRAWN BY: TRC

CHECKED BY: TRC

MAP DATE: 10/29/2021

SCALE: 1 inch = 175'

SUMMIT CARBON SOLUTIONS
MIDWEST CARBON EXPRESS
GARY L. KNOPF

TAX ID: 1618300007
TRACT NUMBER: IA-WE-302-0150.000

REV NO.	DATE	DESCRIPTION
A	11/1/2021	INITIAL ISSUE
B	3/10/2022	REVISED WORKSPACE

DRAWING NO. BW-MCE-ACQ-IA-WE-302-0150.000

PROJECT NO. 450959 SHEET NO. 01 of 01

EXHIBIT C
ADDENDUM OF SPECIAL CONDITIONS

This Exhibit C is attached to and incorporated into that Easement Agreement between Landowner and Company (the "Easement Agreement"). Landowner and Company agree that to the extent the following provisions of this Exhibit conflict with the provisions of the Easement Agreement, the provisions of this Exhibit shall control.

1. **Pipeline Diameter.** Notwithstanding the diameter stated in Section 1(a) of the Easement Agreement, the pipeline constructed pursuant to the Easement Agreement shall not exceed twelve inches (12") in nominal diameter.
2. **Drain Tile & Terrace Repair.** For so long as Company exercises its rights under the Easement Agreement, if Landowner notifies Company that any drainage tile, terrace or irrigation system on the Grantor's Property has been damaged as a direct result of Company's activities in connection with the Easement Agreement, then Company shall (a) investigate the damages and (b) if Company confirms the claim, then Company shall repair or, if Company deems necessary, replace the damaged portion of such tile, terrace or irrigation system or, at Landowner's option, pay to Landowner the reasonable costs to so repair or replace the damaged portion of such system either at its original location or at such other location as will accomplish its original purpose. Landowner agrees to provide Company with satisfactory documentation of the costs of such repair or replacement.
3. **Abandonment.** If Company permanently ceases the use of and abandons the pipeline for a period of five (5) consecutive years, Landowner and Company shall comply with the abandonment requirements of 49 C.F.R. part 195 and Iowa Code chapter 479B, except that Landowner and Company agree that Company shall abandon the pipeline in place.
4. **Above Ground Appurtenances.** Company shall cause no above-ground appurtenances to be constructed on the Easements, with the exception of mandatory safety and operation appurtenances and appurtenances otherwise deemed necessary by Company for the safe operation of the Pipeline Facilities, including, without limitation, cathodic test leads and pipeline markers, which when reasonable to do so will be placed in fence lines, points of inflection, stream or creek crossings, pipeline crossings or road right-of-way lines on Landowner's Property.
5. **Restricted Ingress & Egress.** Except in cases of emergency, ingress and egress on Landowner's Property shall be limited to the Pipeline Easement, Temporary Construction Easement, any area of Access Easement or other rights of way specifically shown on Exhibit B and any public rights of way.
6. **Easement Agreement Unchanged.** Except as specifically modified in this Exhibit, the terms of the Easement Agreement remain unchanged and in full force and effect.
7. **Capitalized Terms.** Capitalized terms not otherwise defined in this Exhibit shall have the same meaning as set forth in the Easement Agreement.

Initials 