

MENG TREE FARM
M. SESSION SURVEY, A-824
J. JOHNSON SURVEY, A-450
R. J. ESKRIDGE SURVEY, A-254
CHEROKEE COUNTY, TEXAS
(170.02 ACRES)
L-2200413

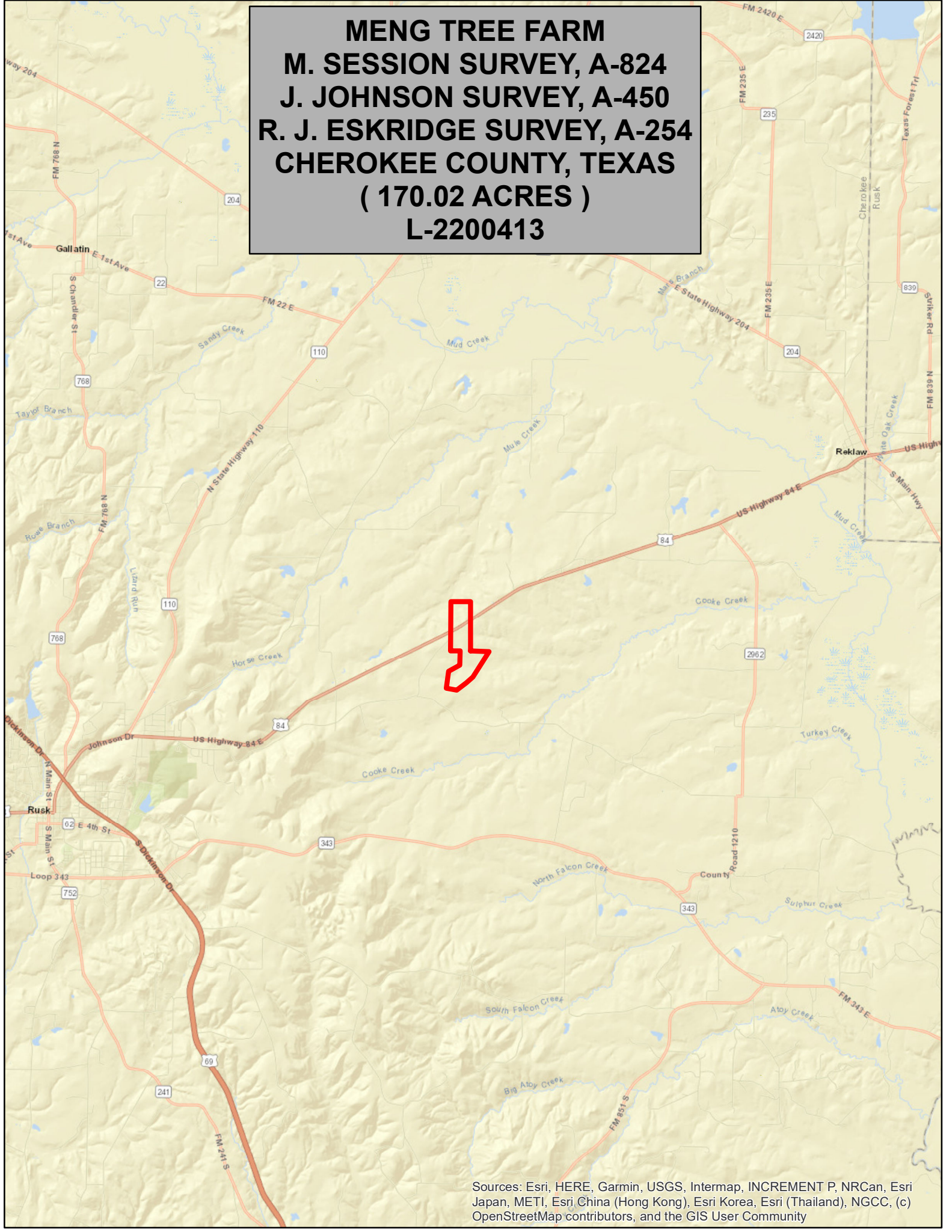

Sources: Esri, HERE, Garmin, USGS, Intermap, INCREMENT P, NRCan, Esri Japan, METI, Esri China (Hong Kong), Esri Korea, Esri (Thailand), NGCC, (c) OpenStreetMap contributors, and the GIS User Community